

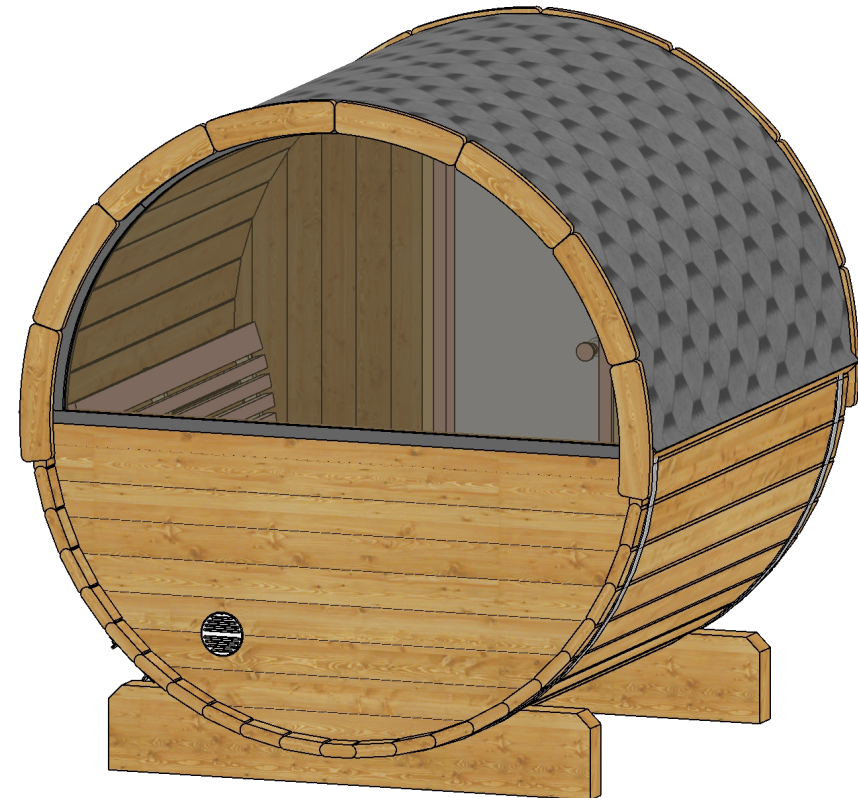

Ergo-Series E6W Barrel Sauna
Half Glass Window 59D" x 81H"

Almost Heaven Group LLC - <https://www.almostheaven.net>
sales@almostheaven.net - (304) 645-2310



Note: Please read manual before construction

Rev 4/2023

Front & Back Walls

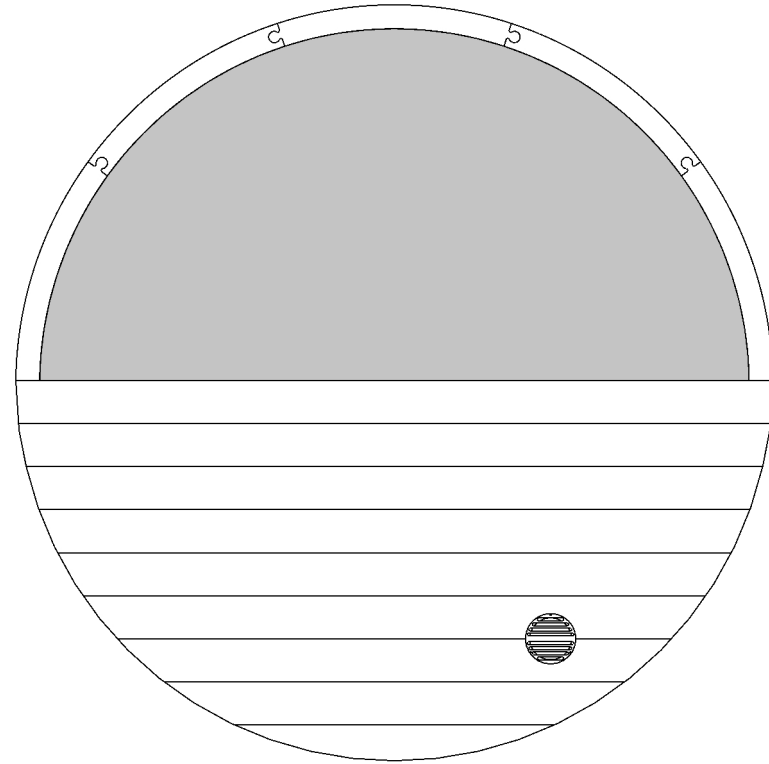
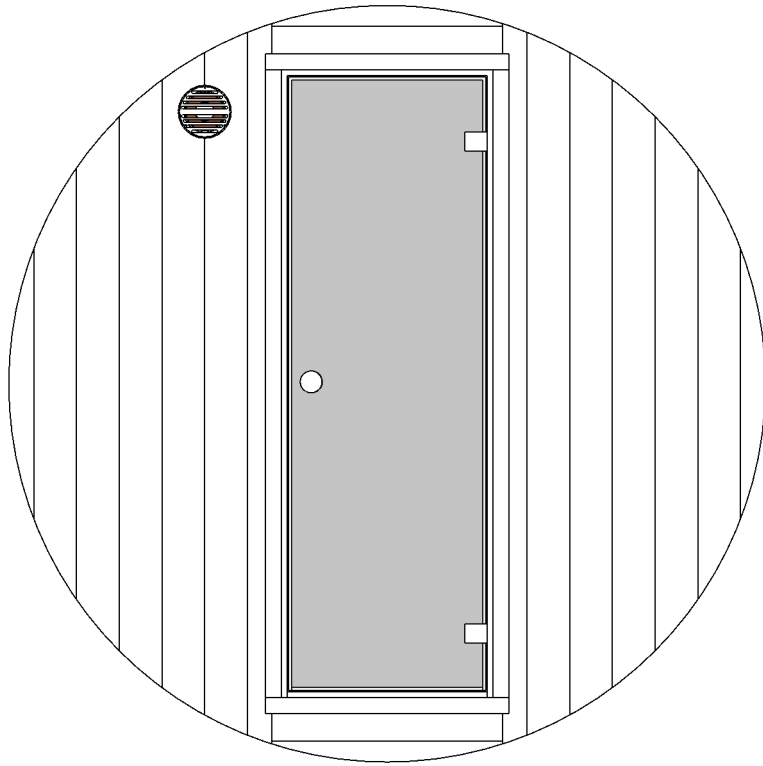

E6W Barrel Sauna 59D" x 81H"

Details list.

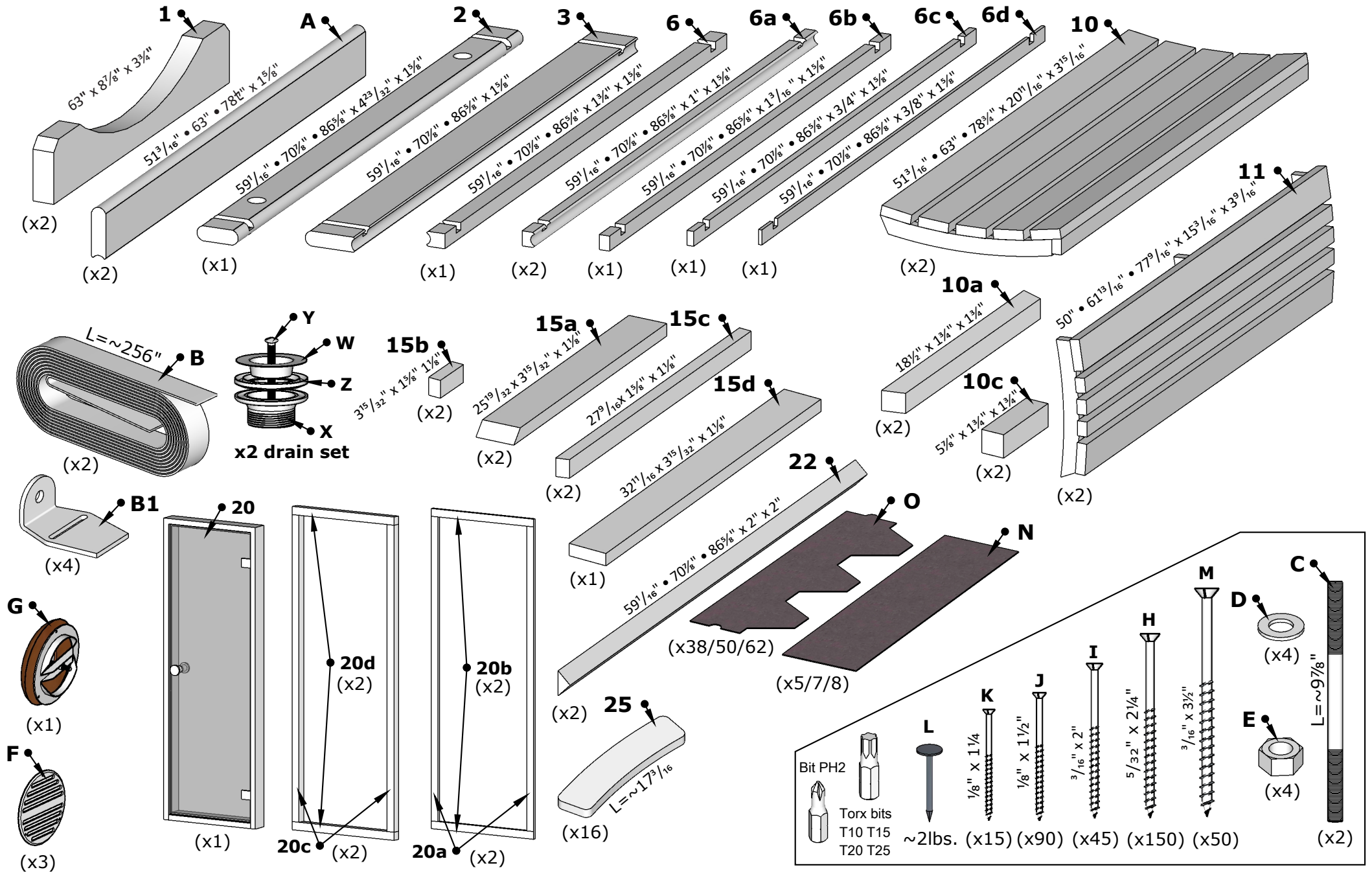

Tools needed

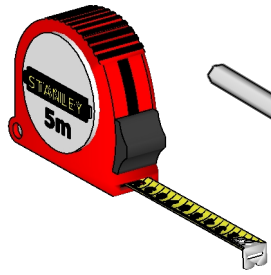

Measuring tape

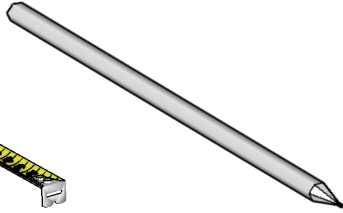

Marker pen

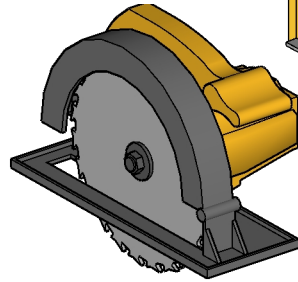

Circular saw

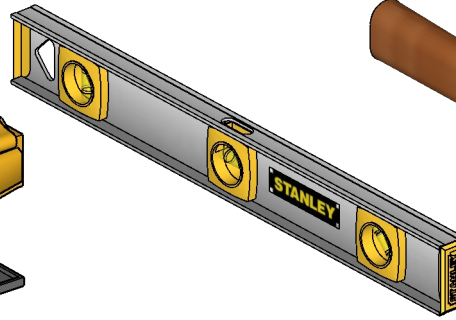

Water level

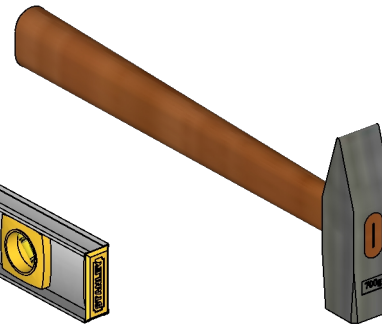

Hammer



Extra hands



Ratchet strap

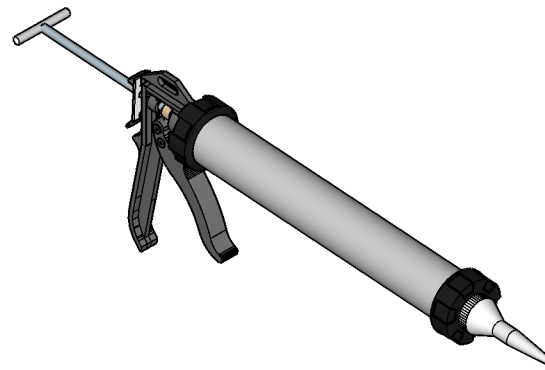

Silicone gun
(Only glass-wall models)

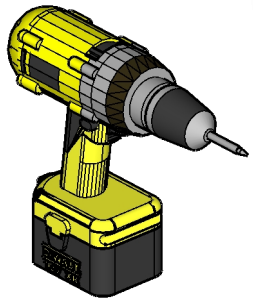

Drill

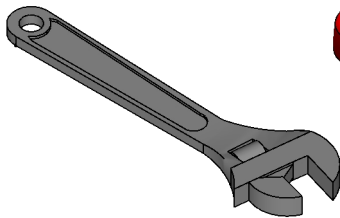

Crescent wrench



Utility knife

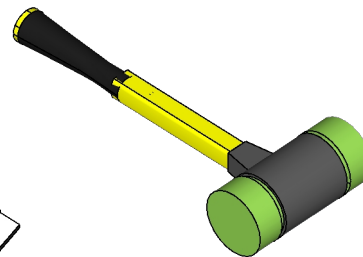

Rubber mallet

Wooden front wall installation

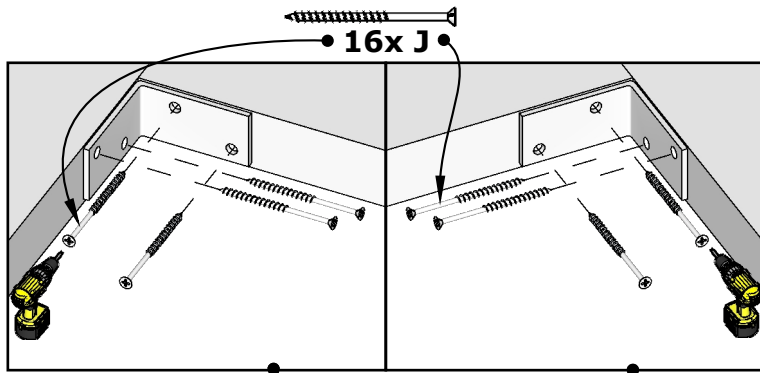
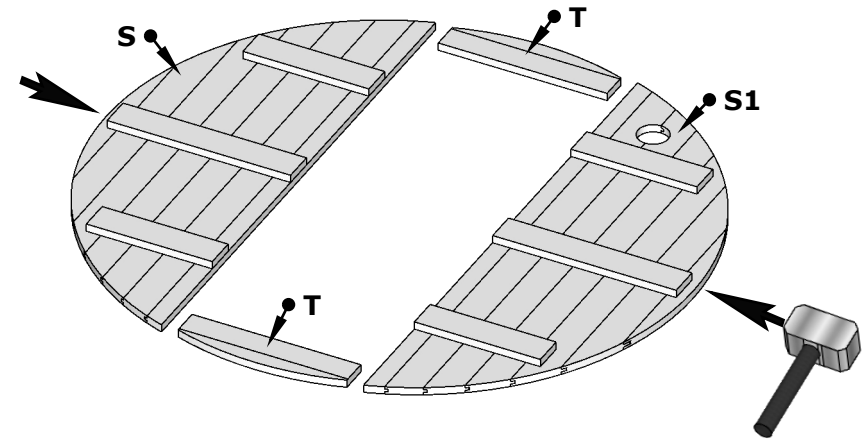
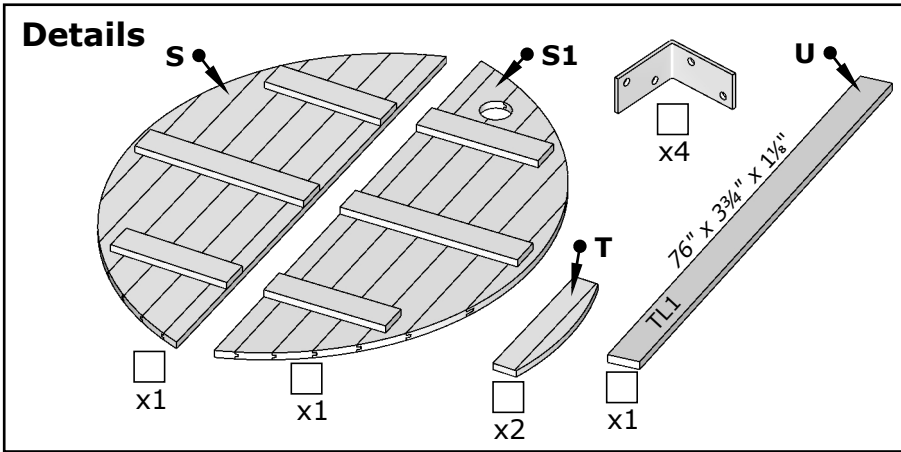

DET U Fix it diagonally to make wall more rigid during the installation.

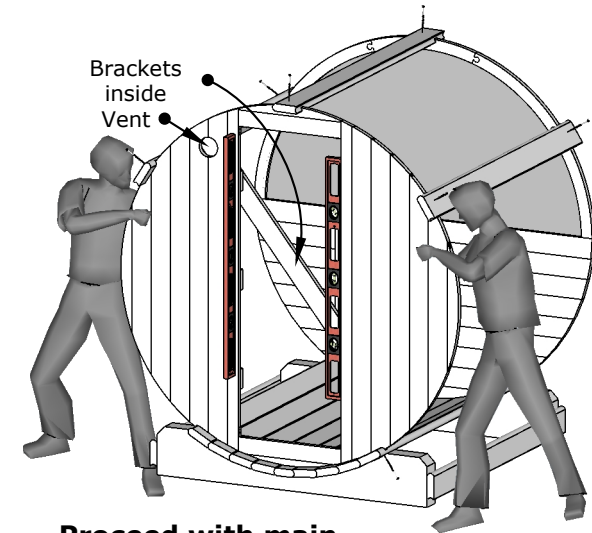
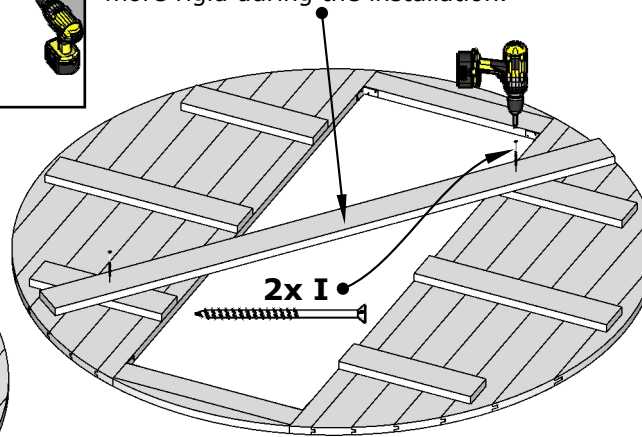

Half-moon wall installation

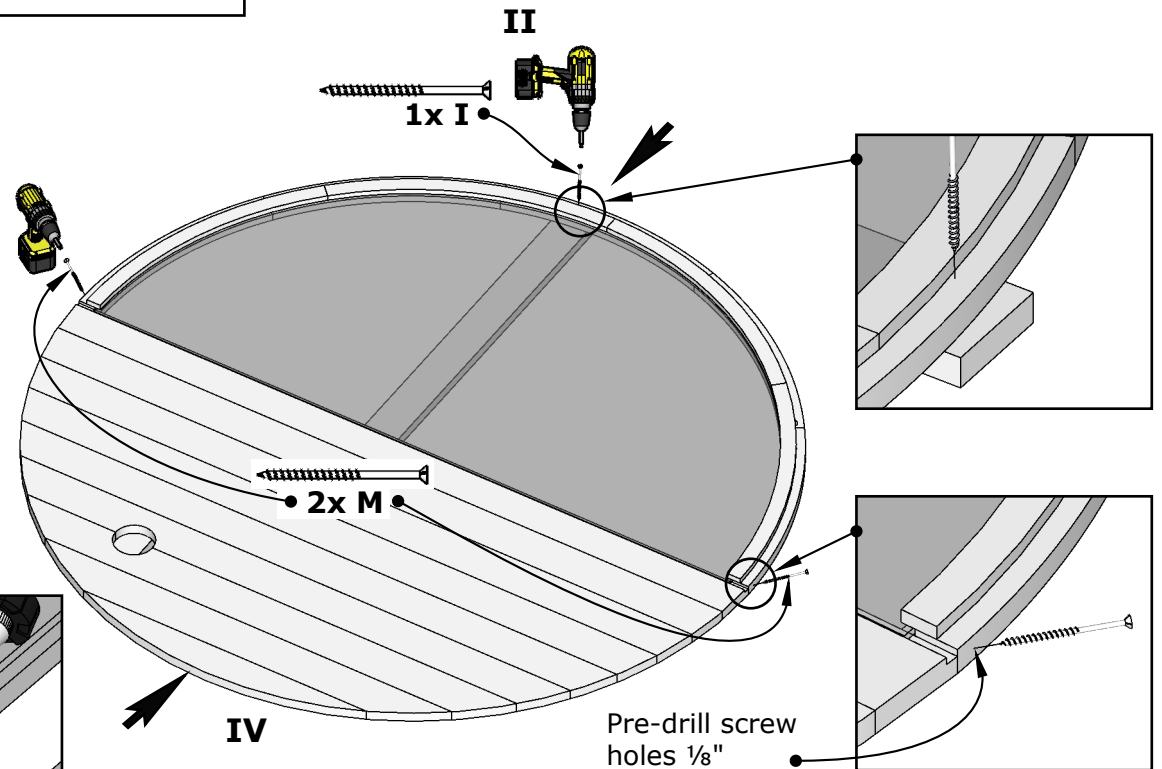
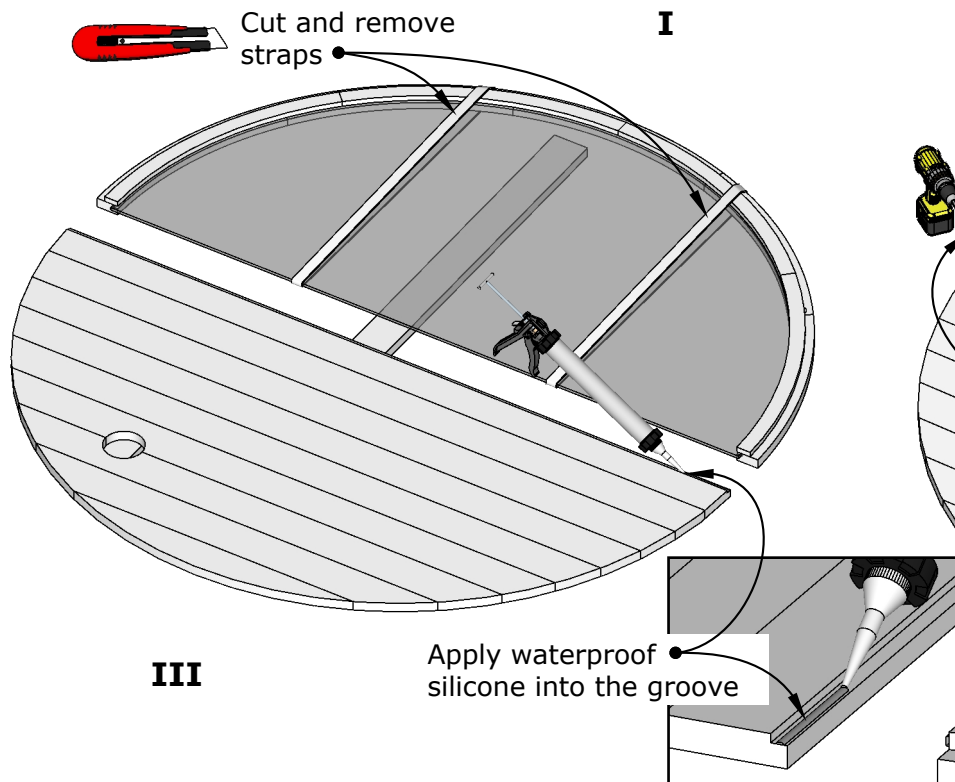
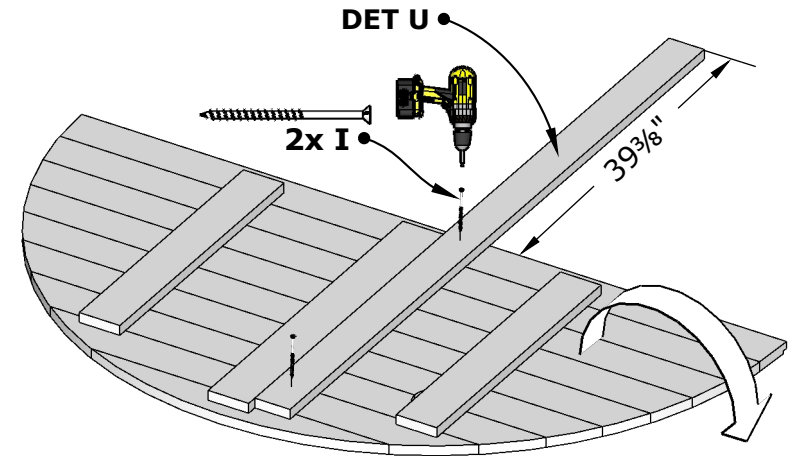
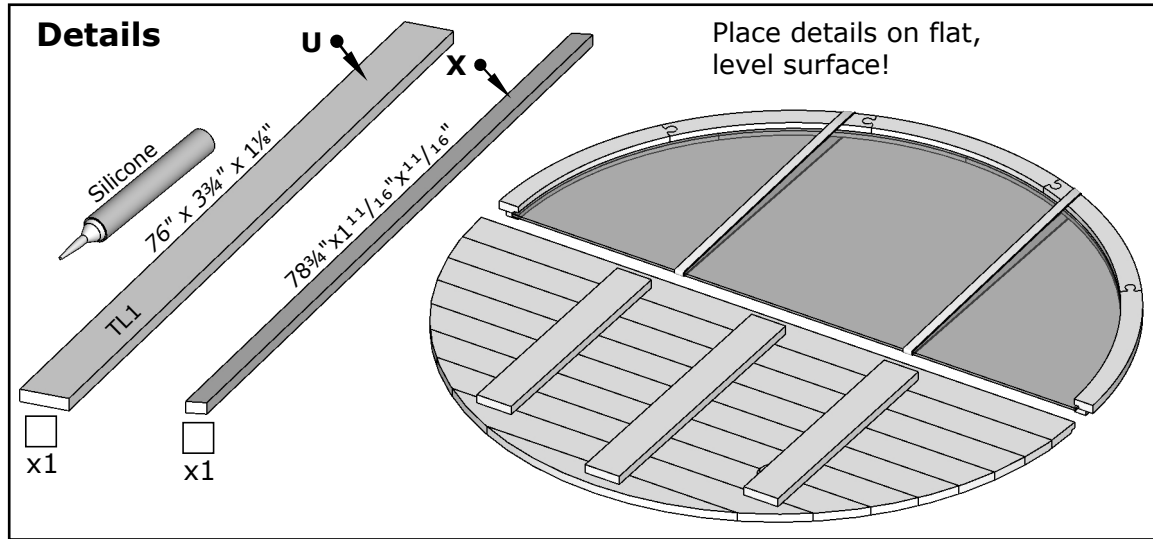

WARNING: Do not let screws touch glass!

Half-moon wall installation

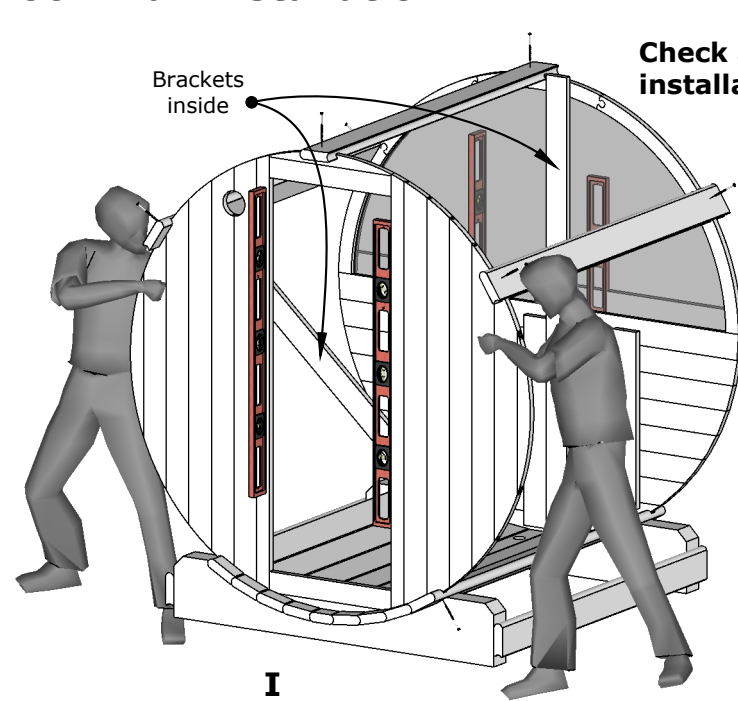

Check also main installation manual.

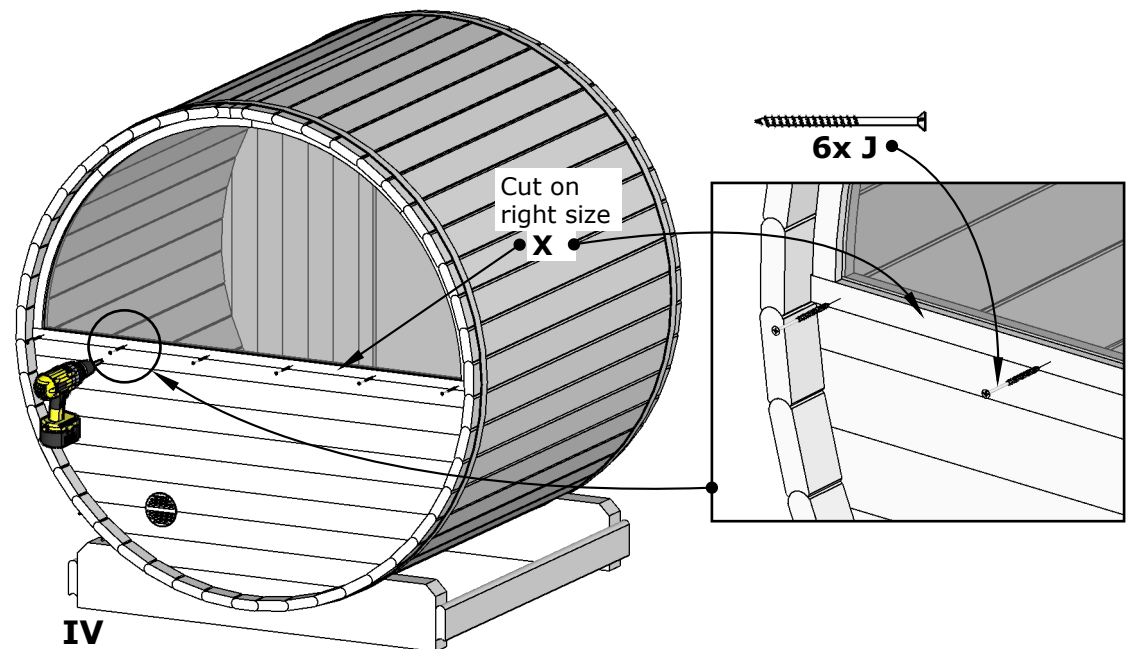
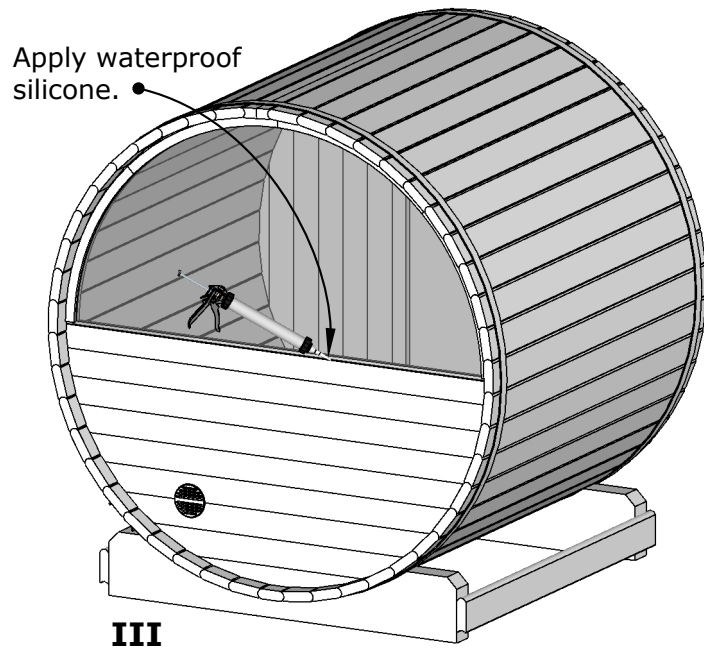
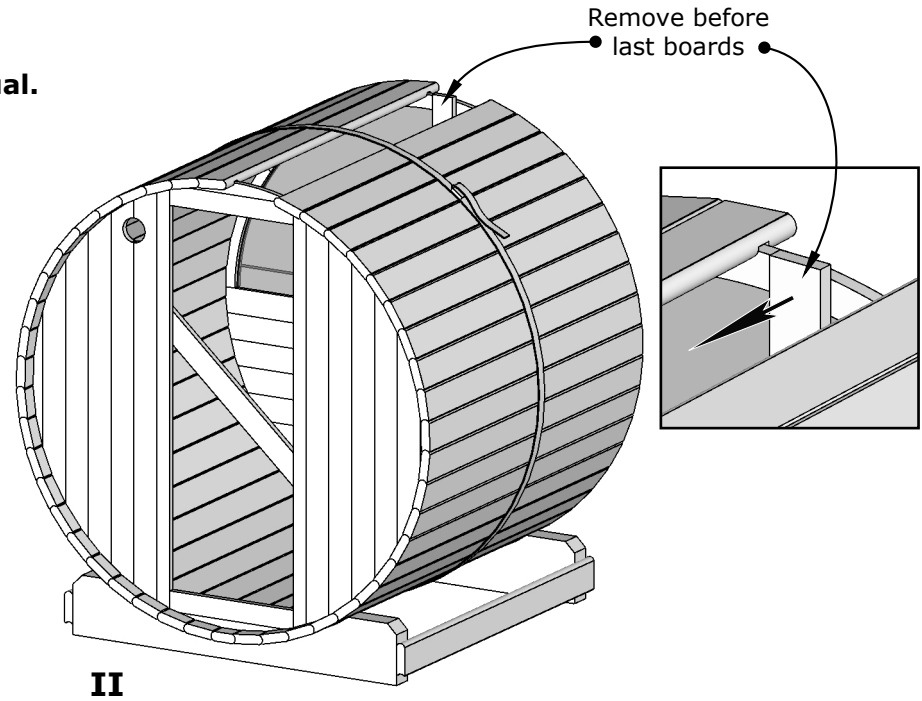

E6W Barrel Sauna 59D" x 81H"

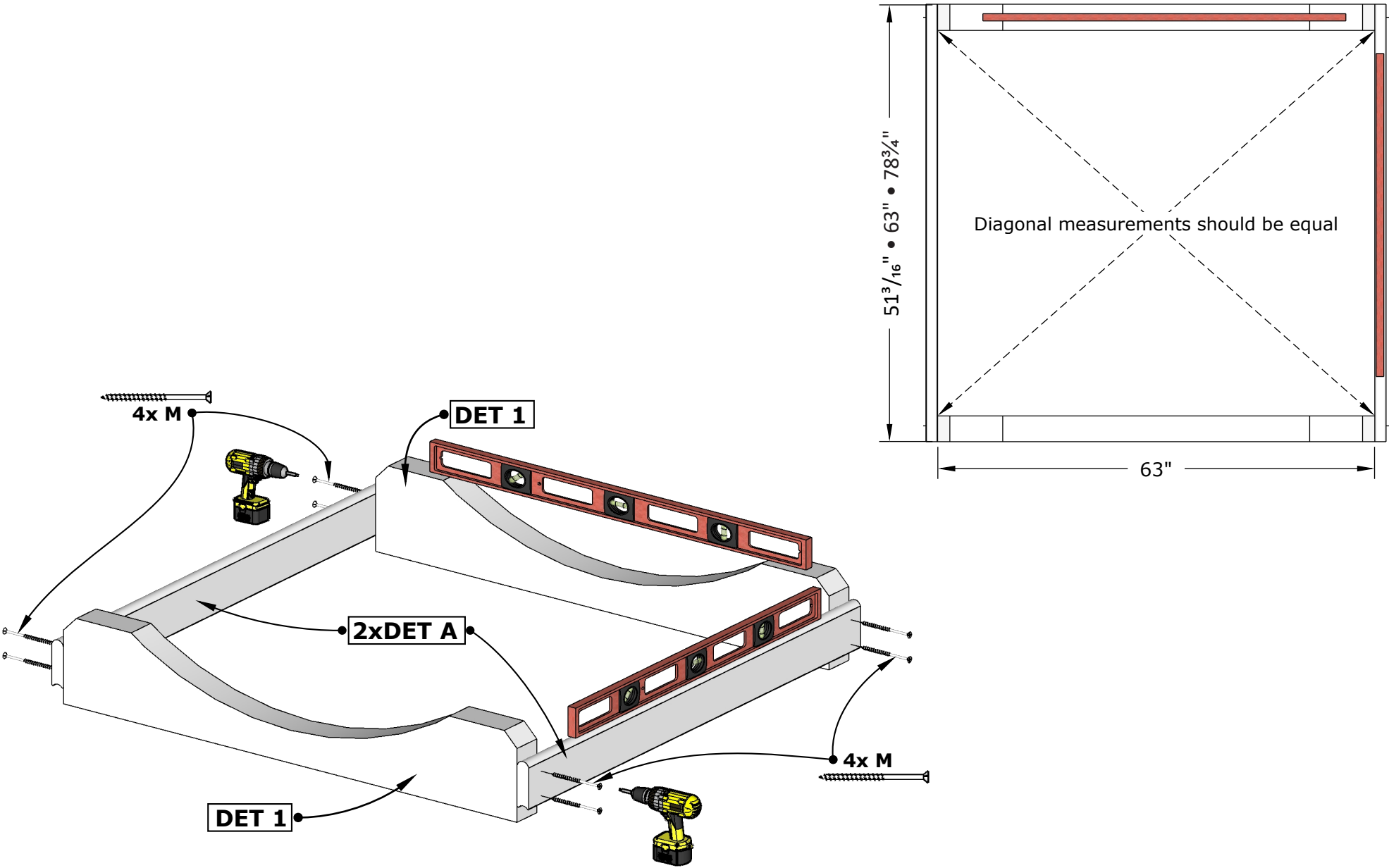

1.

E6W Barrel Sauna 59D" x 81H"

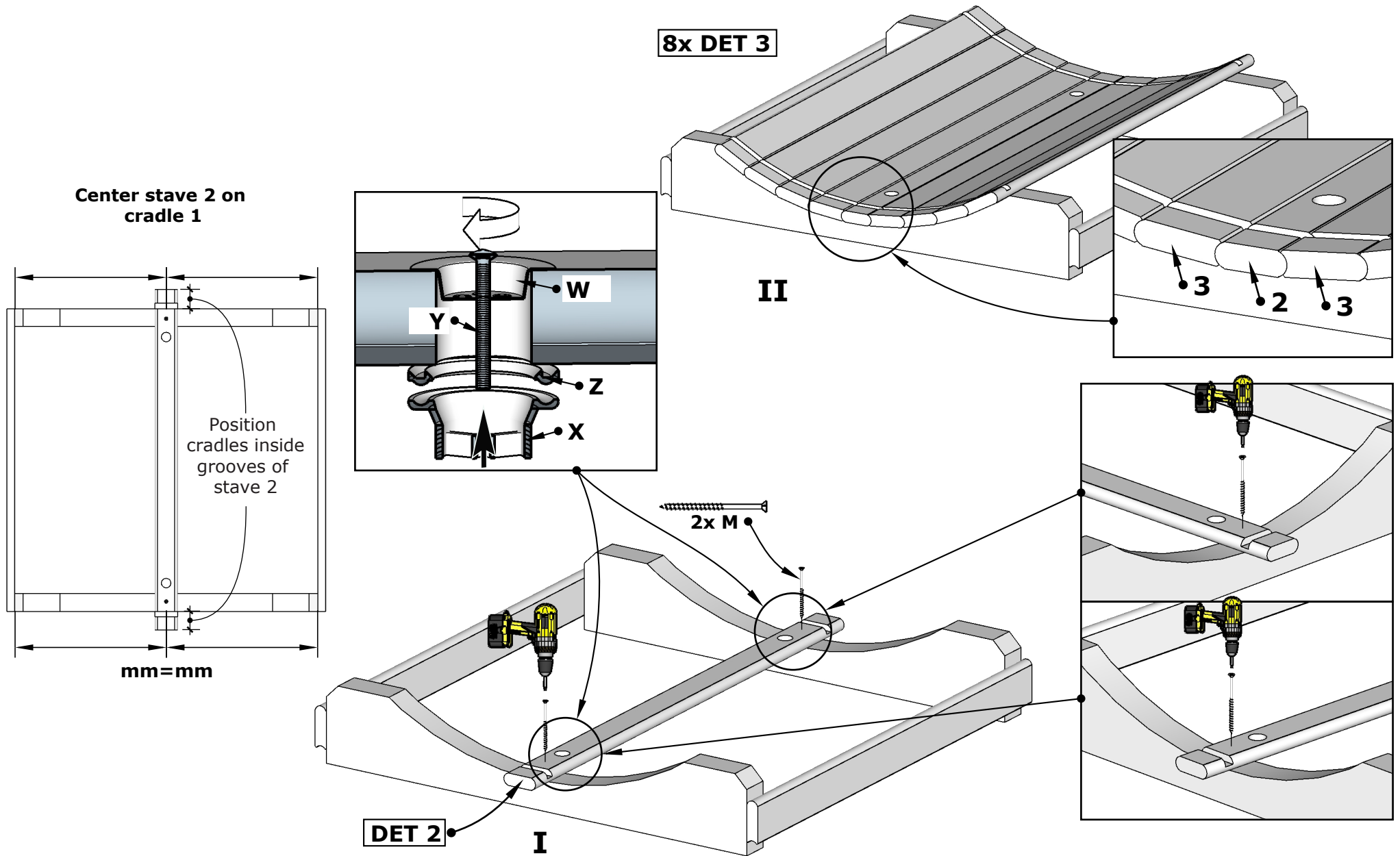

E6W Barrel Sauna 59D" x 81H"

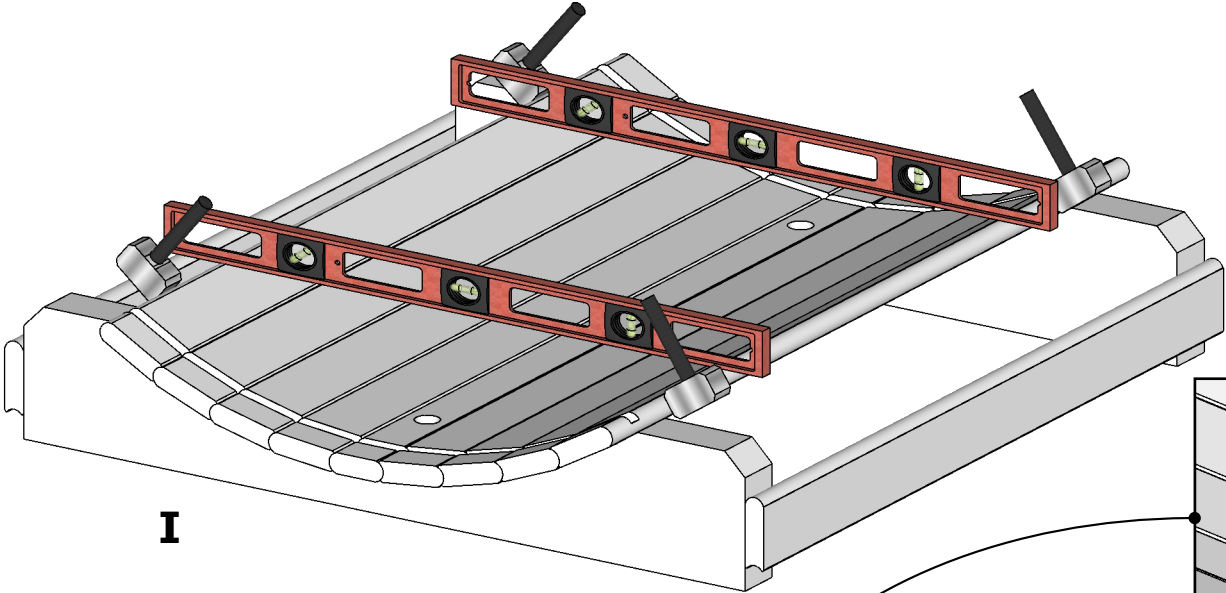

I

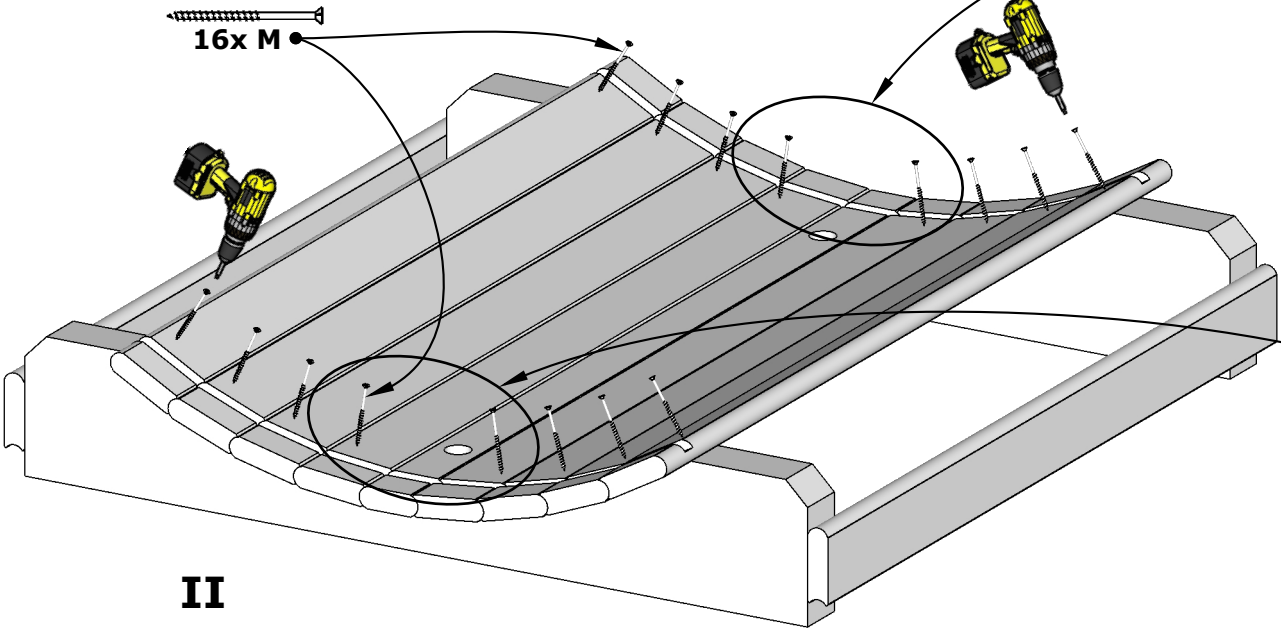

II

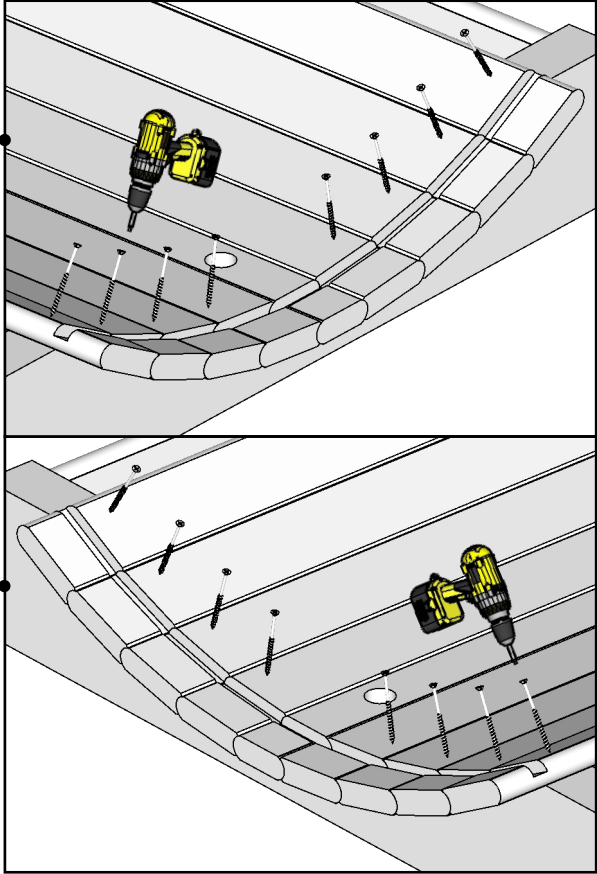

E6W Barrel Sauna 59D" x 81H"

Drill 4 holes $\varnothing 1/2"$
through DET 2
outside

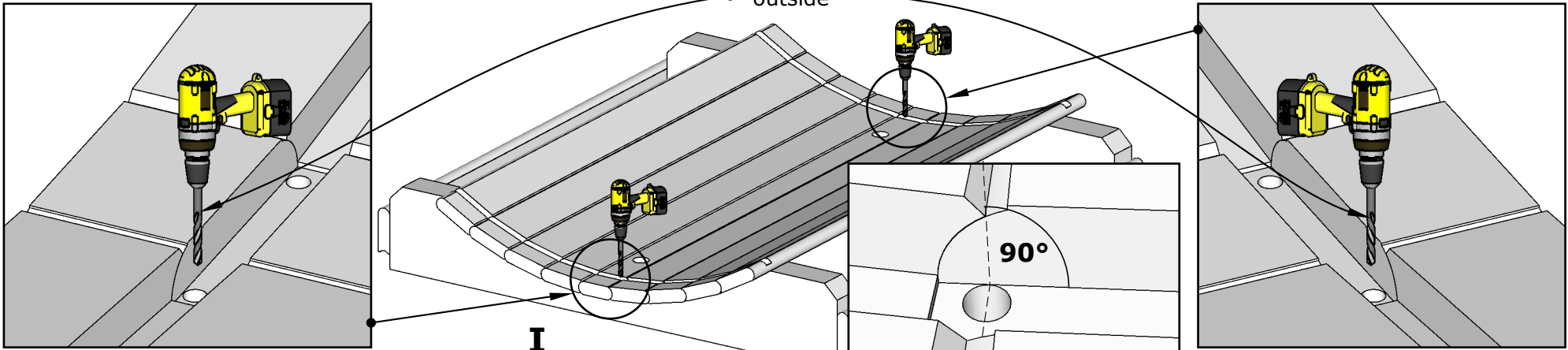

I

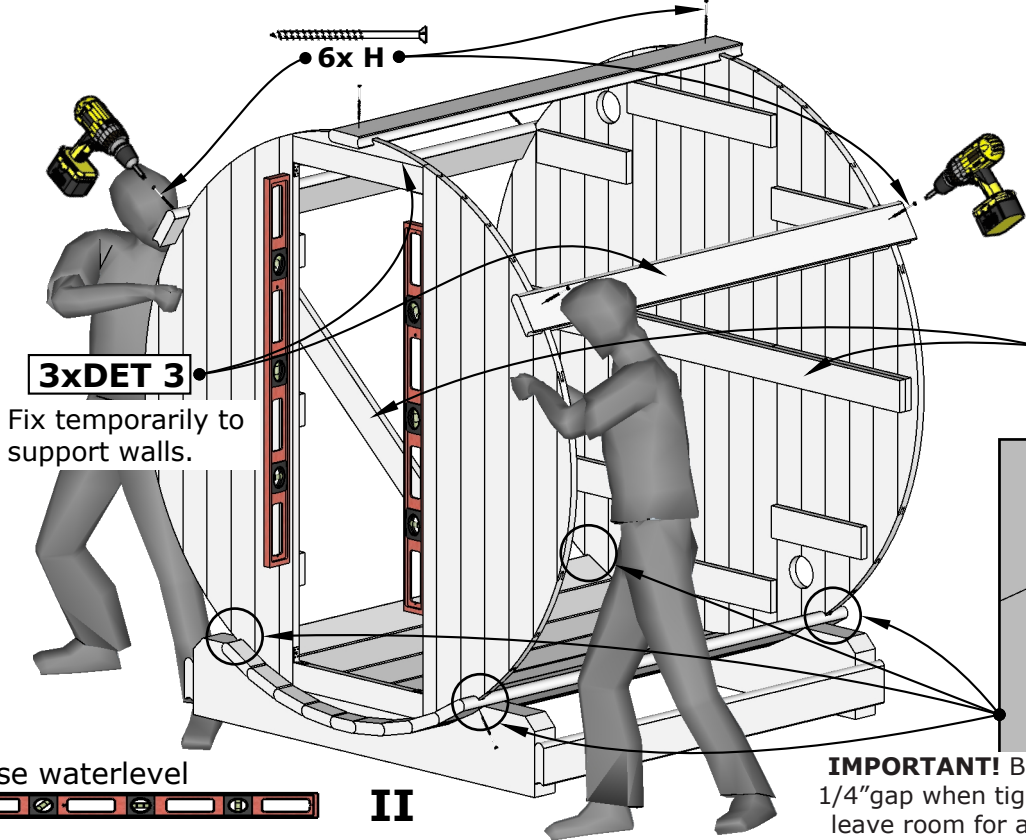

3xDET 3
Fix temporarily to
support walls.

**Check walls installation
manual on extra pages!**

**Sauna wall configuration
depends on Your model!**

Brackets inside



II

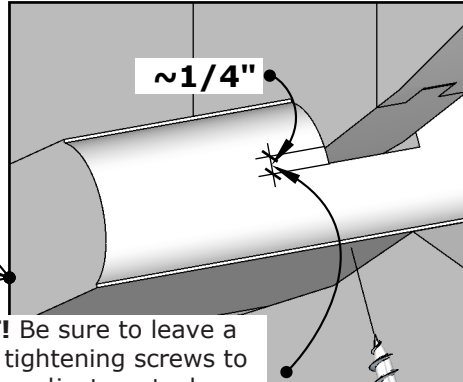

IMPORTANT! Be sure to leave a
 $1/4"$ gap when tightening screws to
leave room for adjustment when
the outer bands (B) are installed.

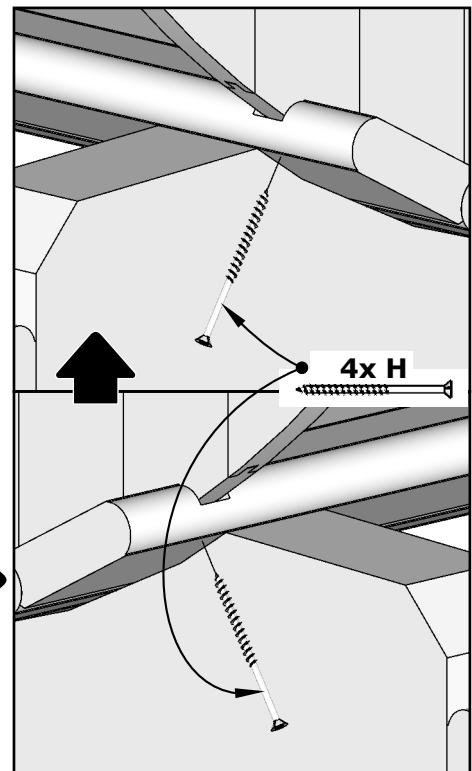

E6W Barrel Sauna 59D" x 81H"

Remove temporary bracing

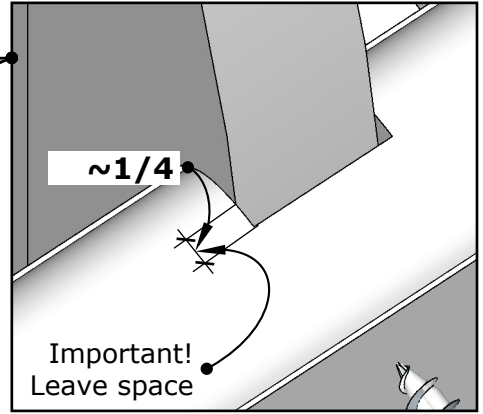
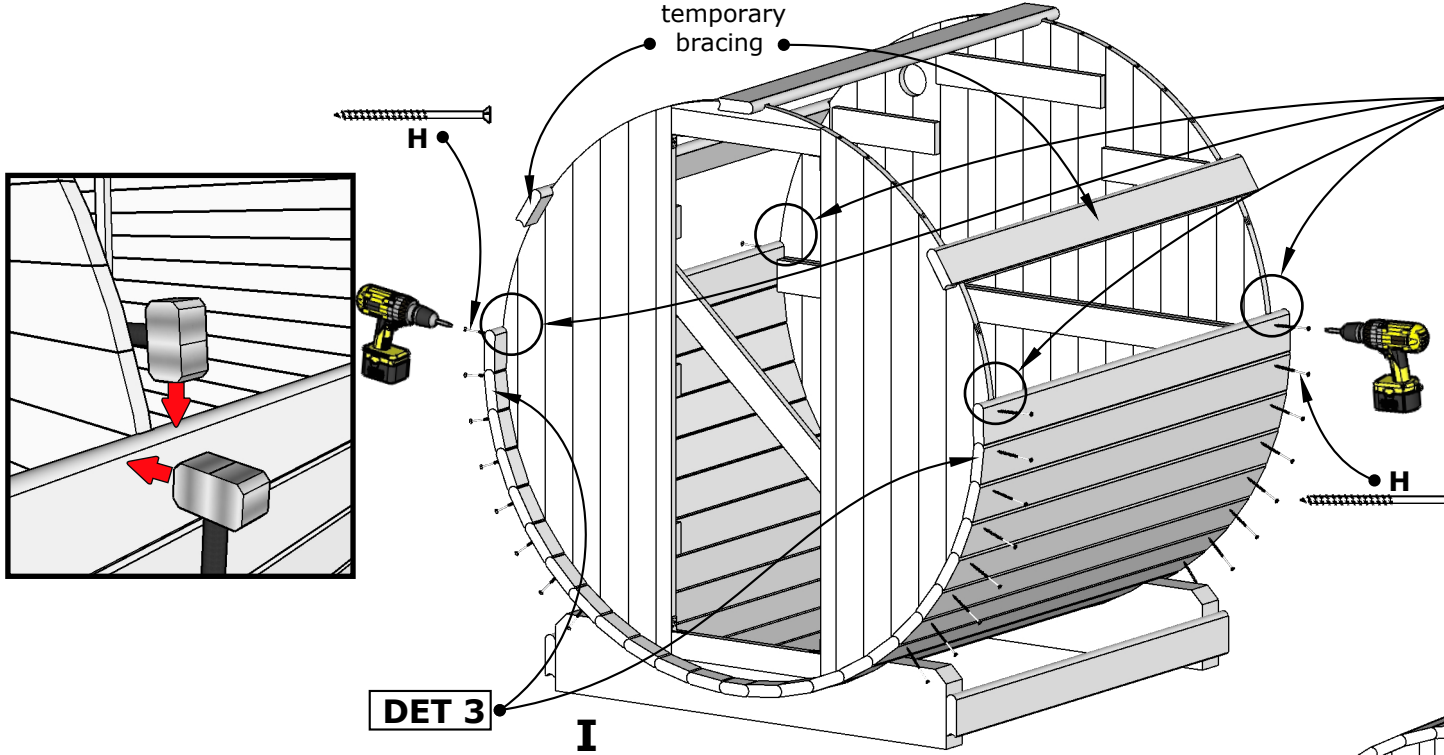

IMPORTANT! Be sure to leave a 1/4" gap when tightening screws to leave room for adjustment when the outer bands (B) are installed.

DET 3
I

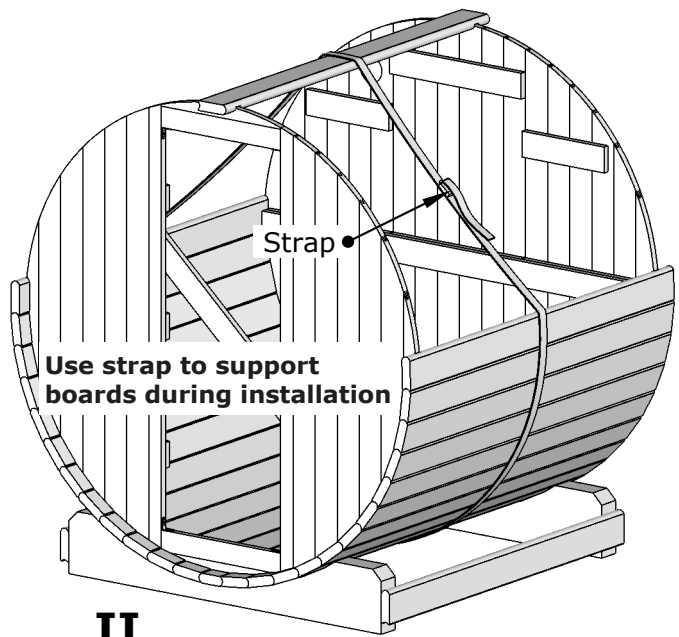

Use strap to support boards during installation

II

See the next page.

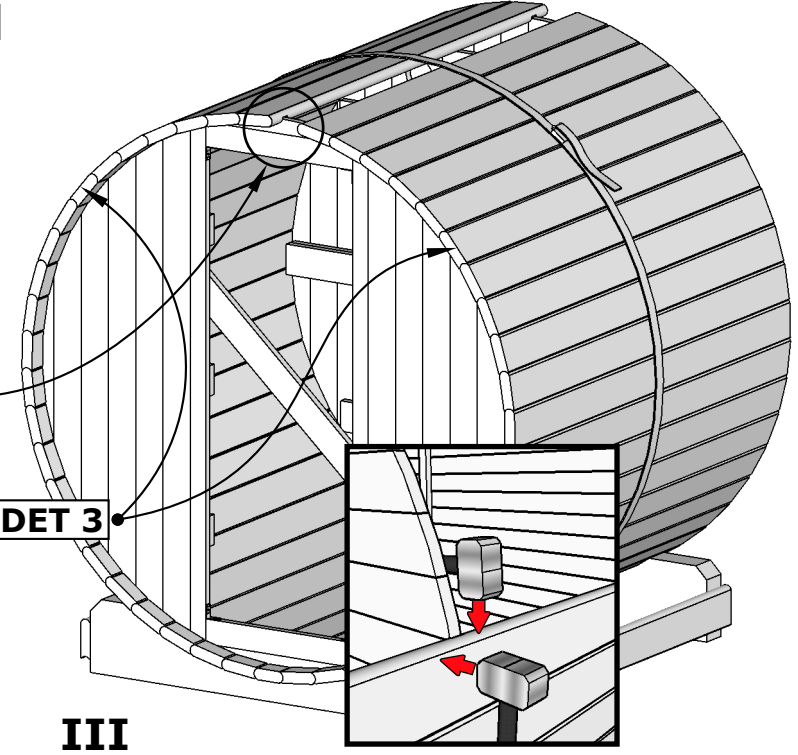
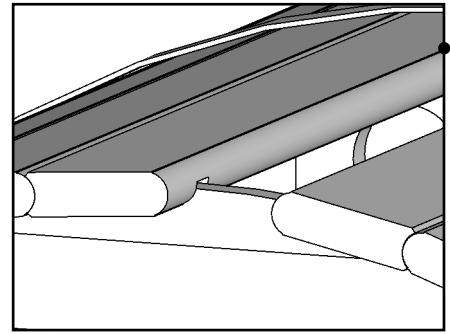

DET 3

III

E6W Barrel Sauna 59D" x 81H"

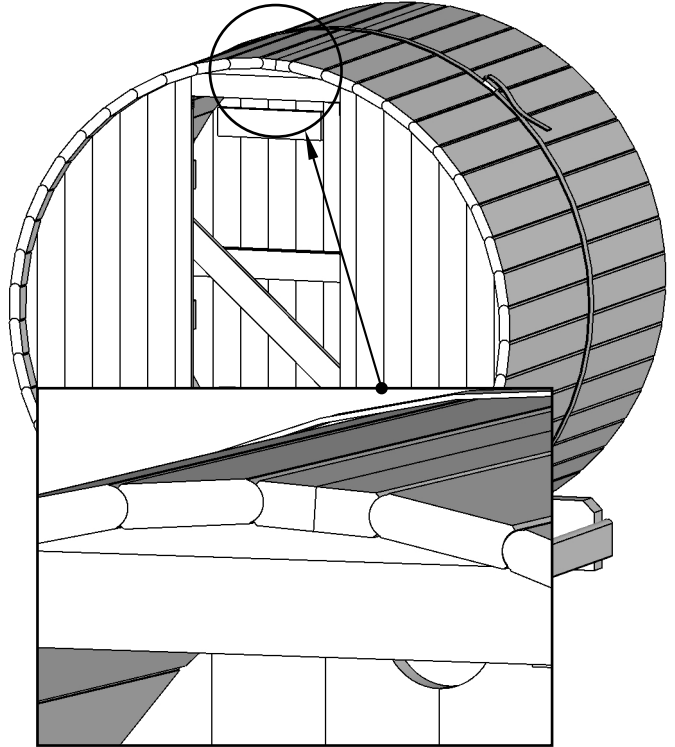
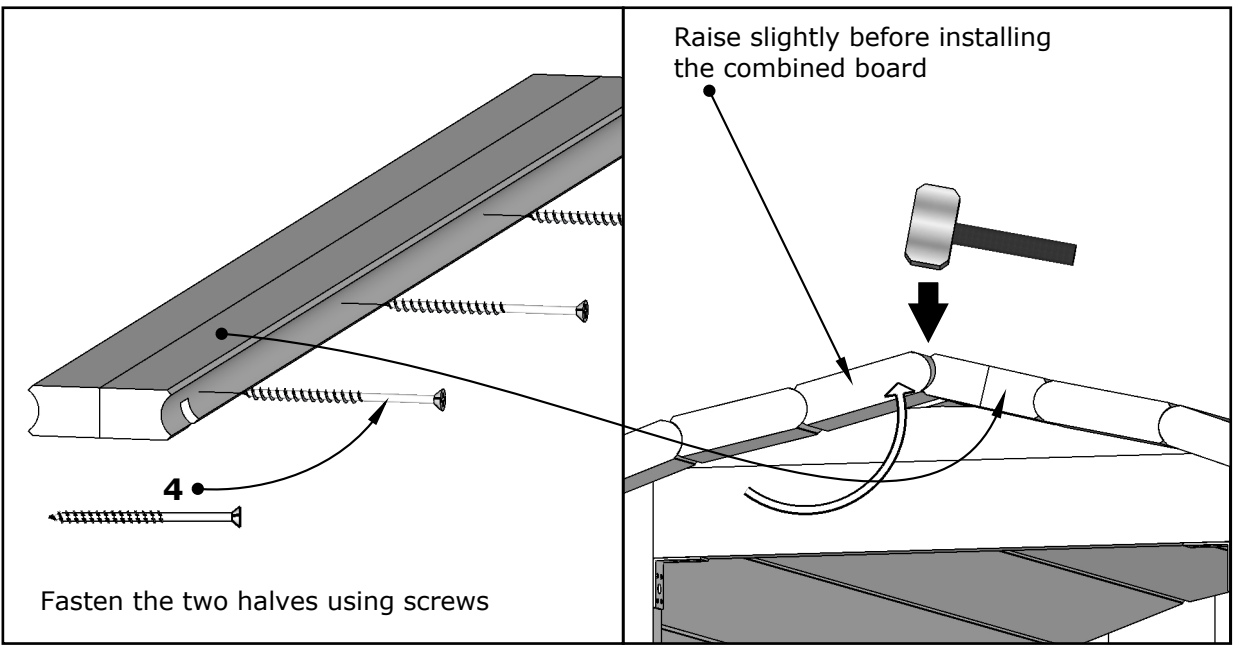
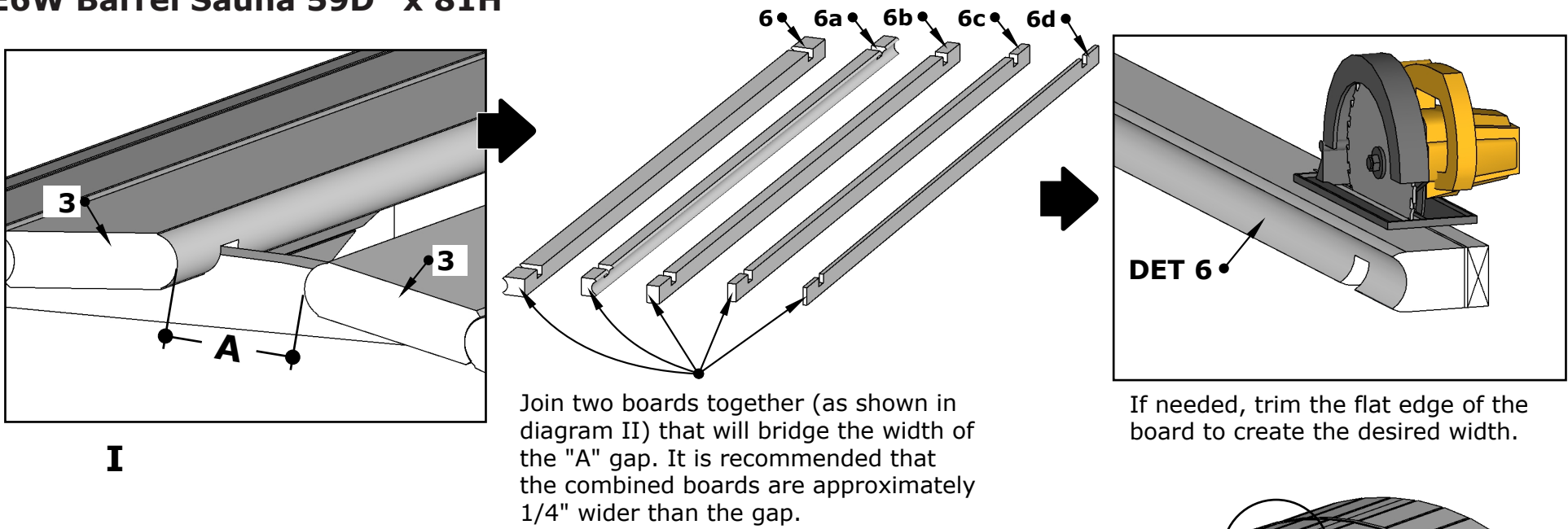

6.

II

III

E6W Barrel Sauna 59D" x 81H"

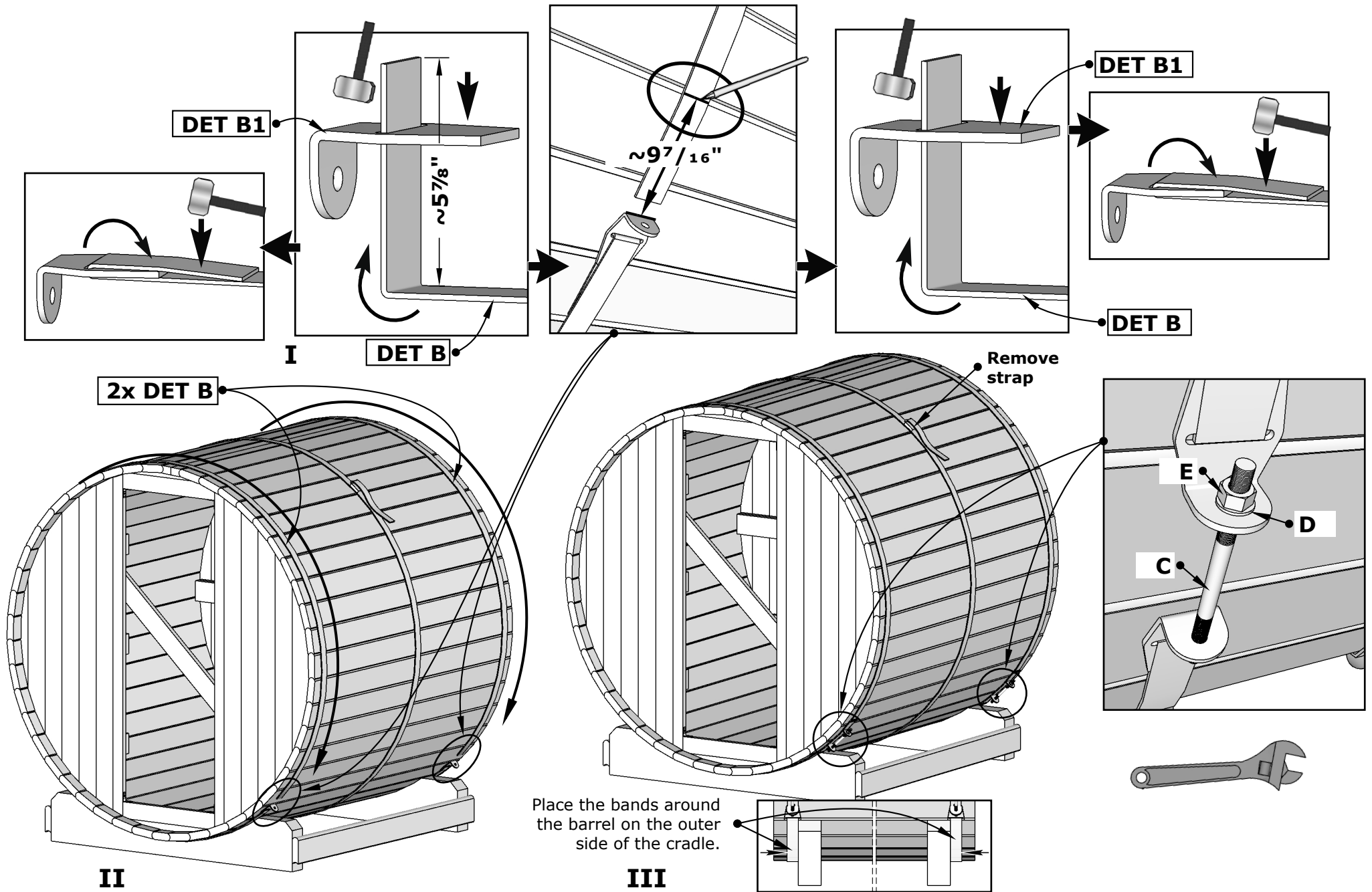

E6W Barrel Sauna 59D" x 81H"

Remove all temporary braces

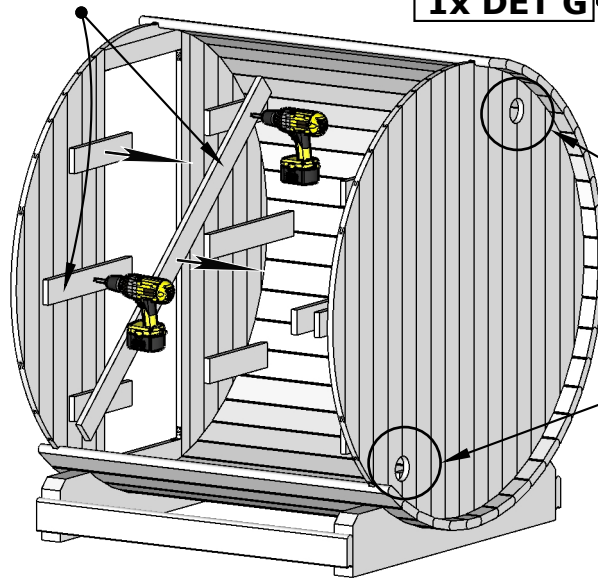
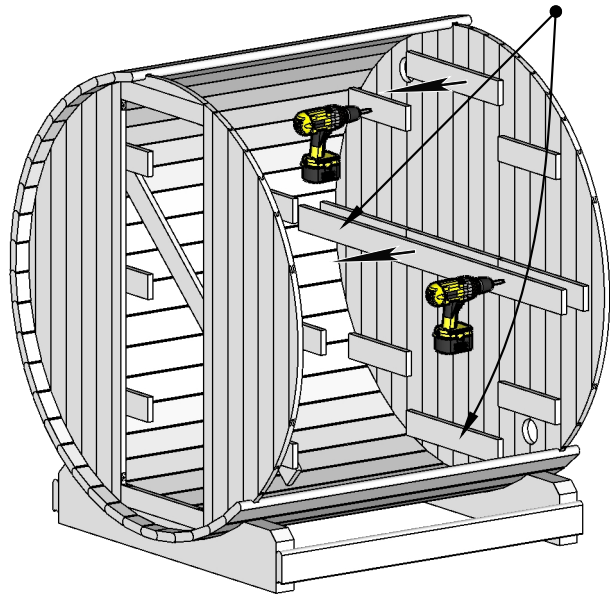

1x DET G

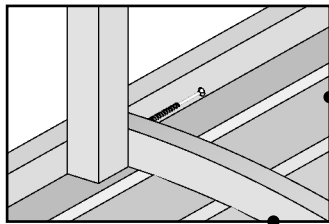
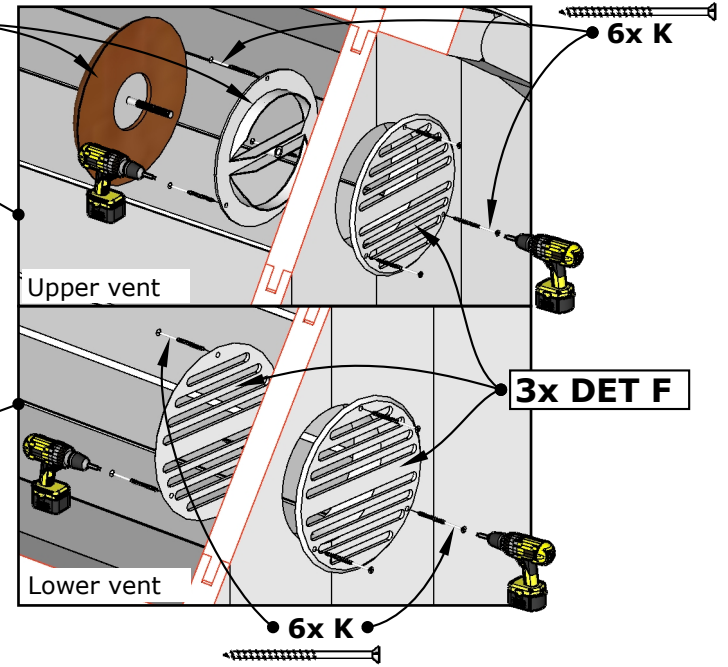

Pre-drill holes Ø5/32" before screws.

I

2x DET 10a

2x H

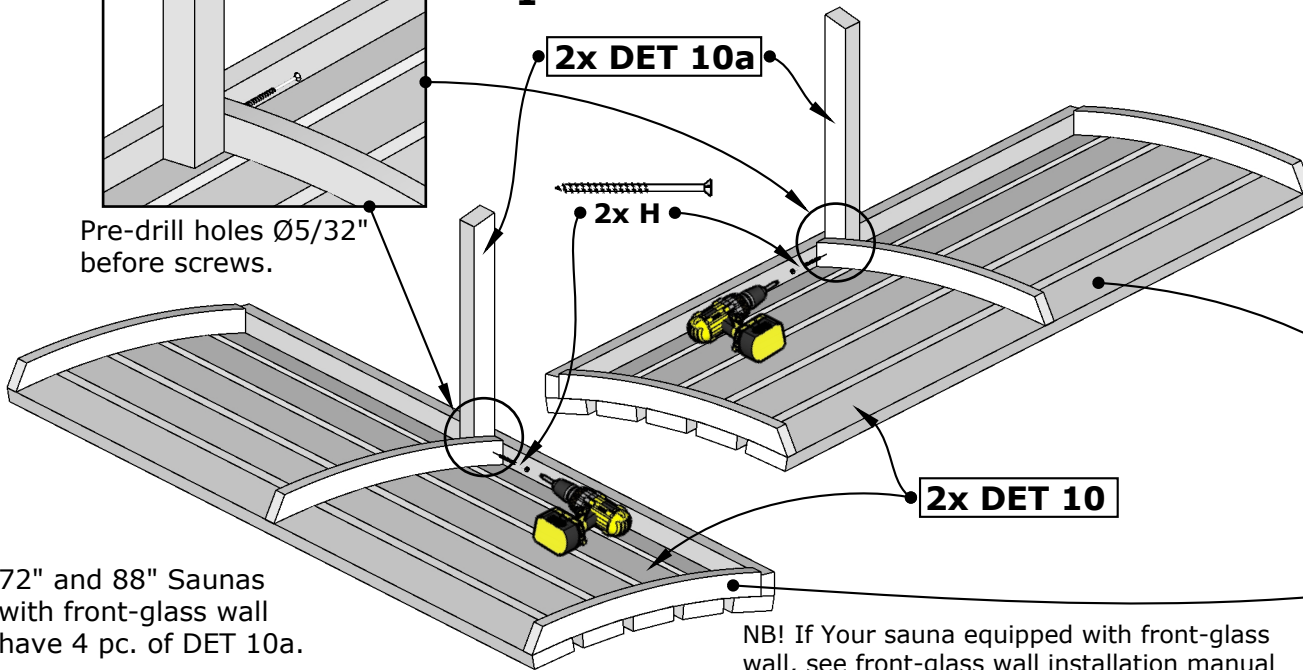

2x DET 10

72" and 88" Saunas with front-glass wall have 4 pc. of DET 10a.

NB! If Your sauna equipped with front-glass wall, see front-glass wall installation manual for proper benches installation.

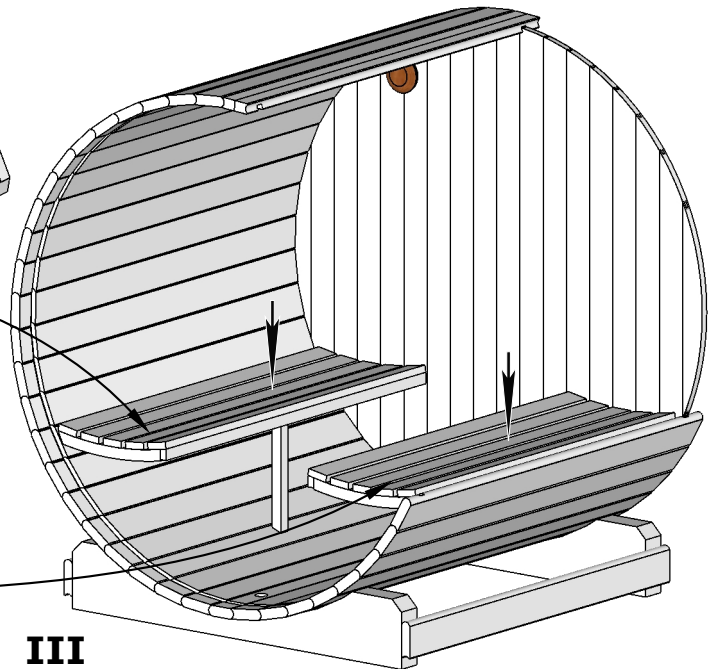

III

8.

II

E6W Barrel Sauna 59D" x 81H"

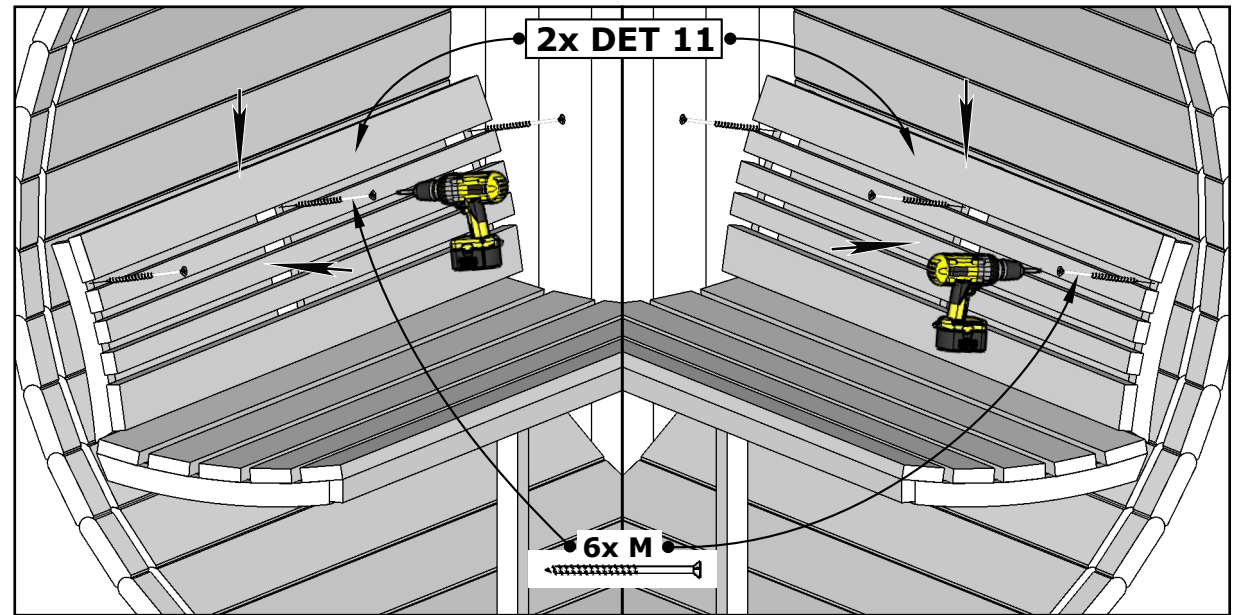
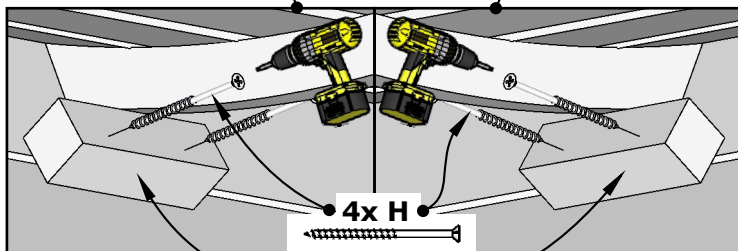
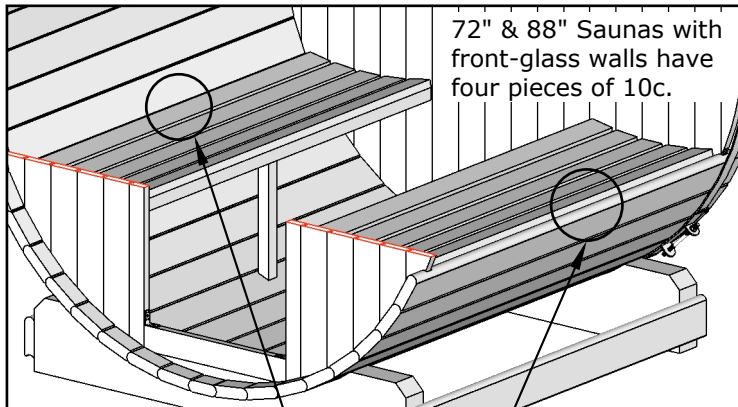
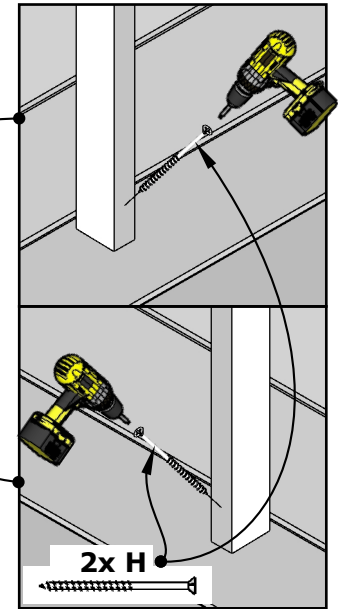
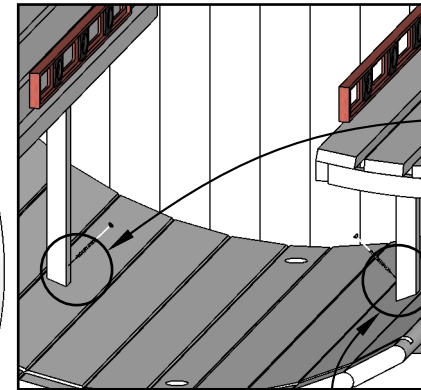
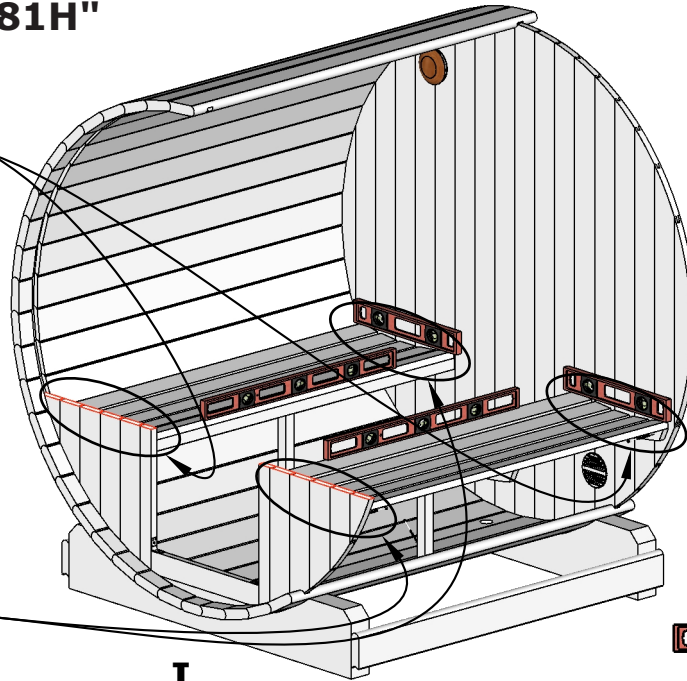
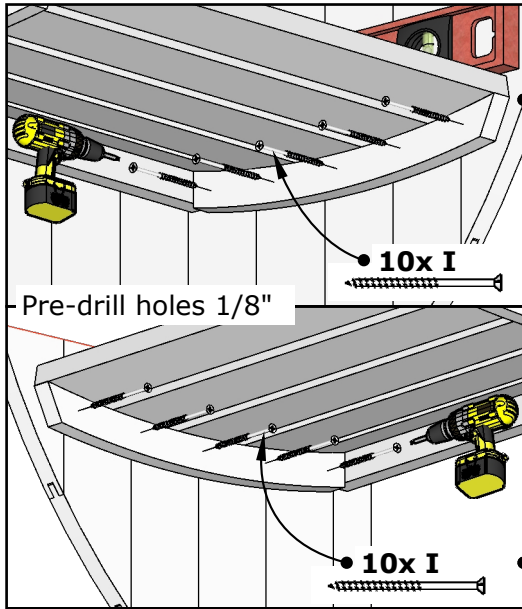

E6W Barrel Sauna 59D" x 81H"

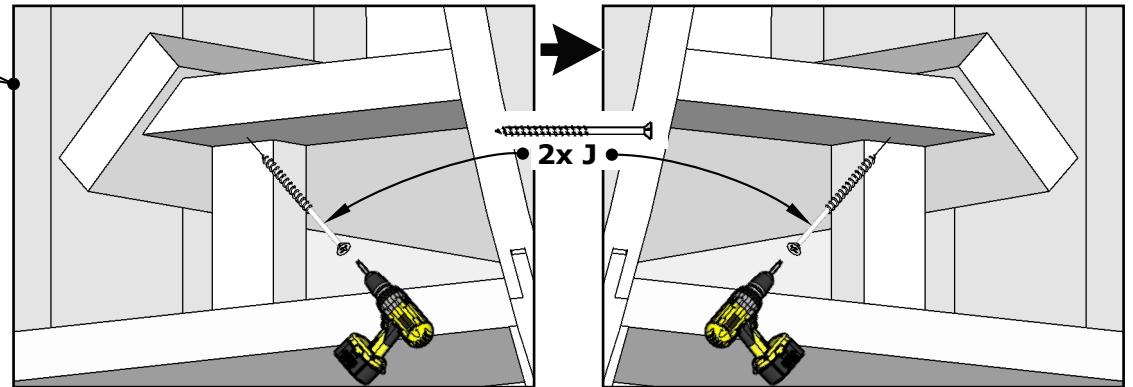
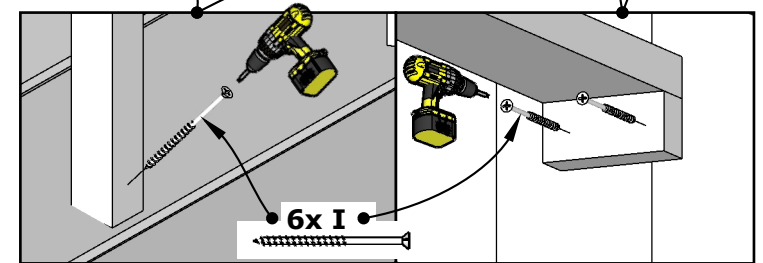
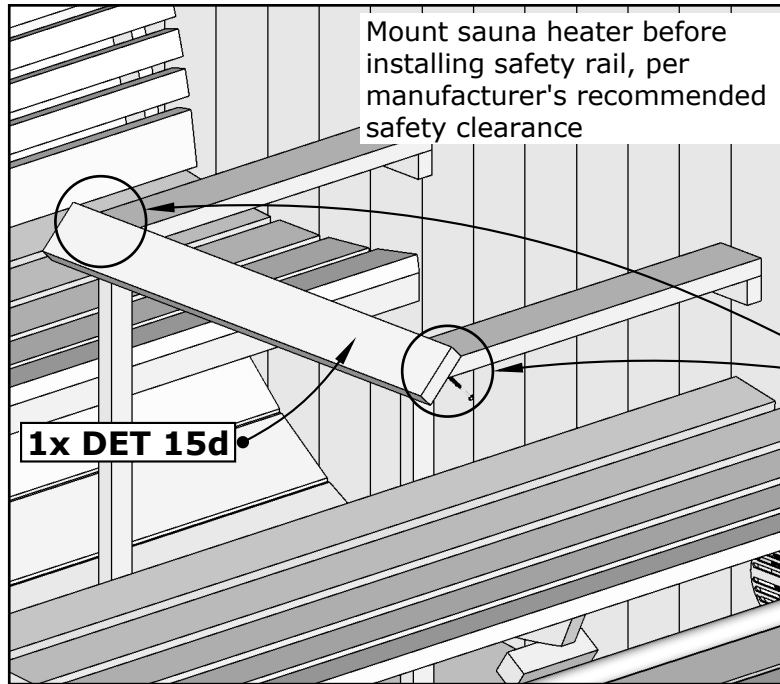
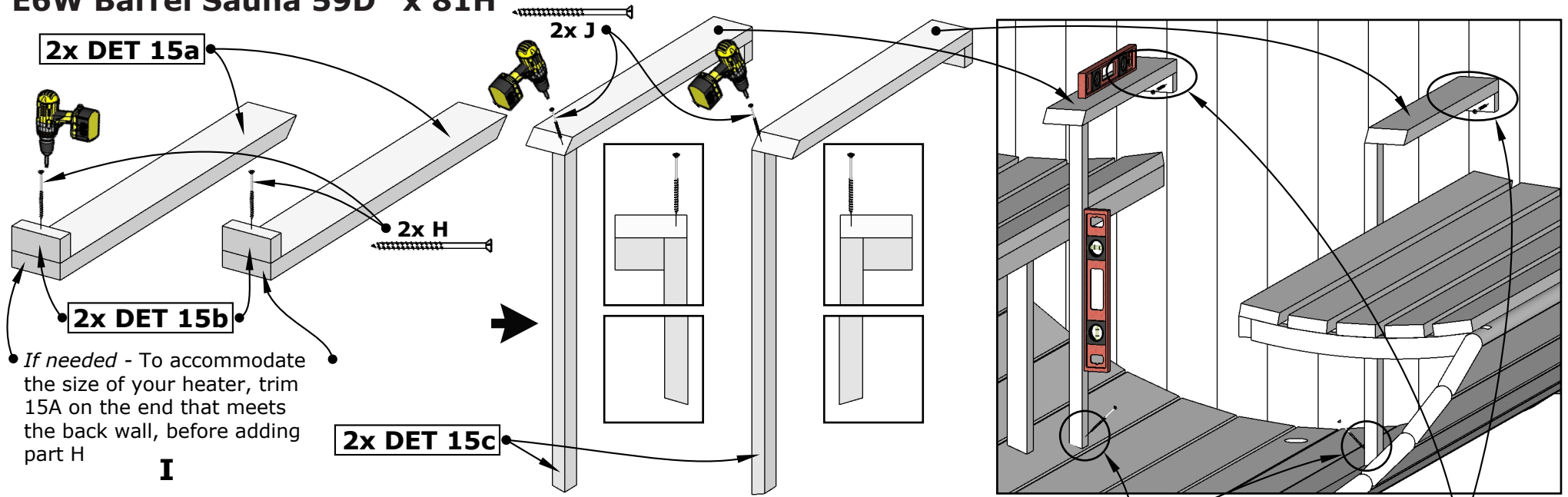

E6W Barrel Sauna 59D" x 81H"

X= Front wall thickness
 Wooden front wall 1 1/8"
 Glass front wall 1 5/8"

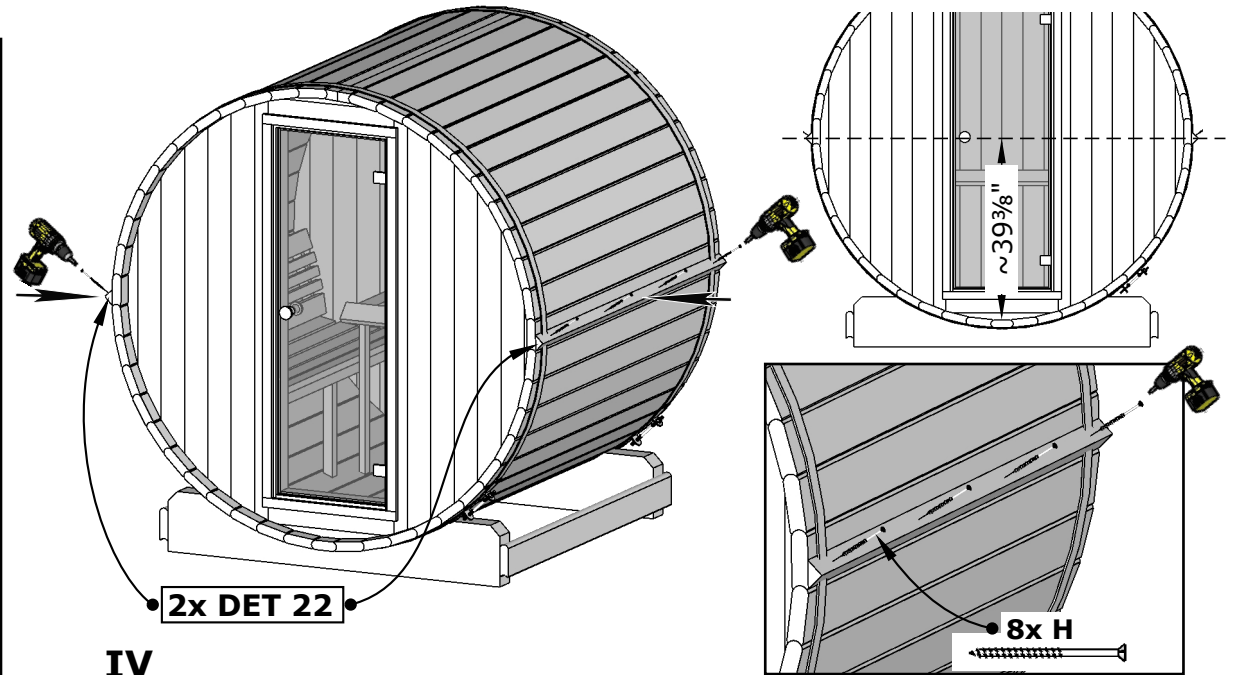
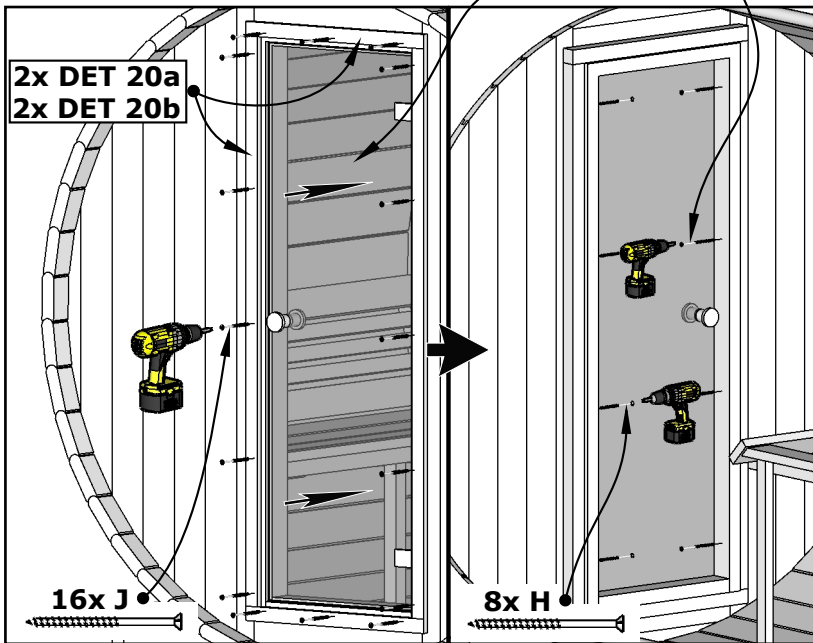
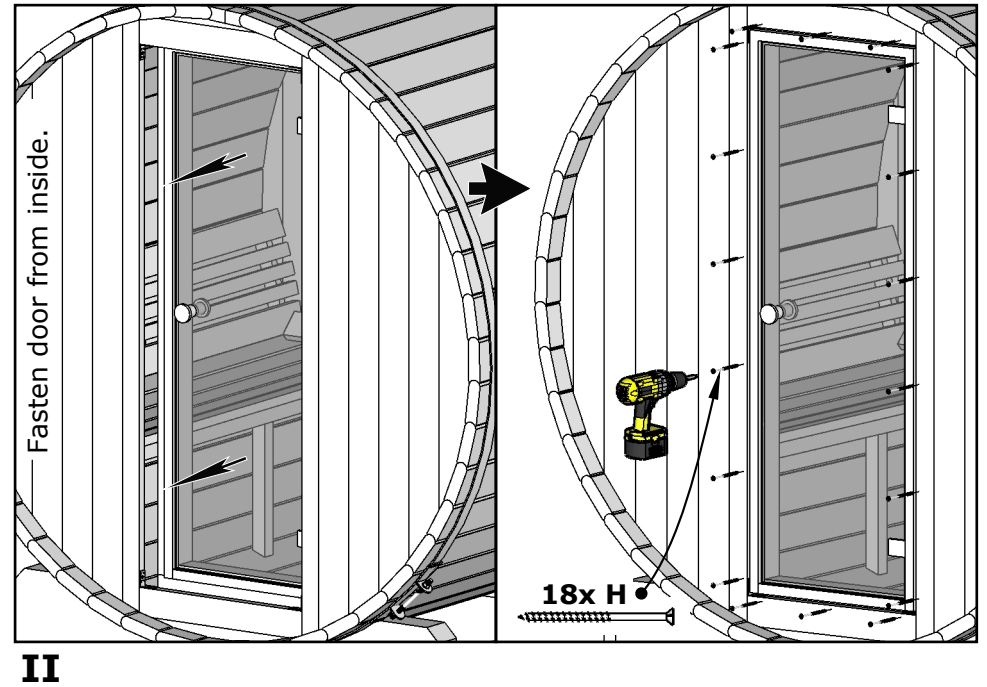
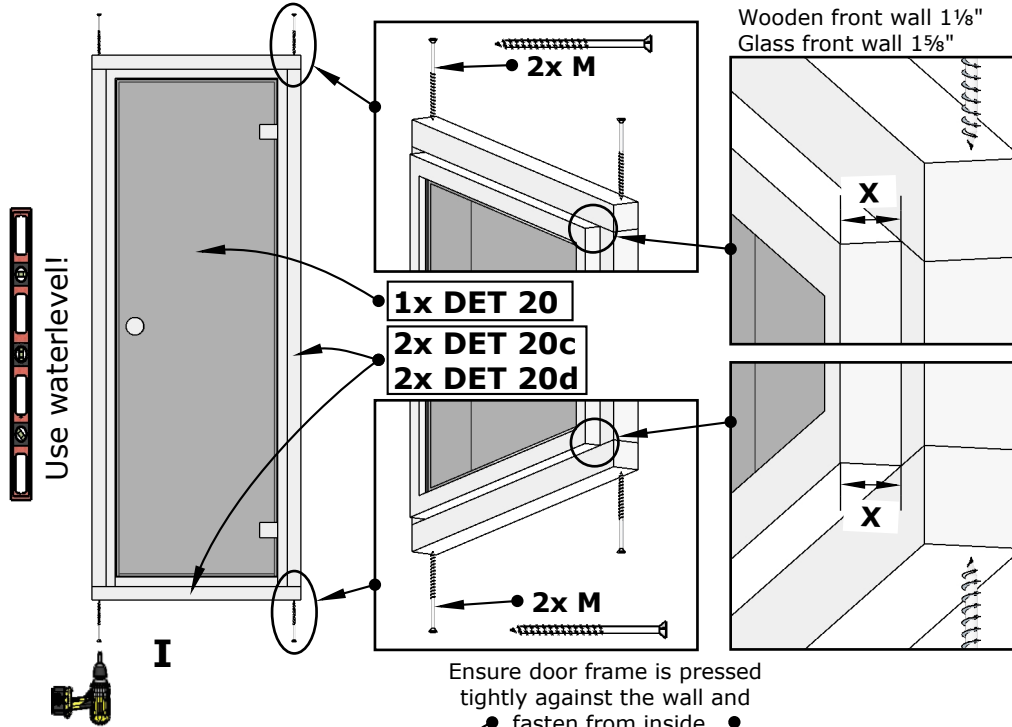

E6W Barrel Sauna 59D" x 81H"

See the installation manual inside the shingles package

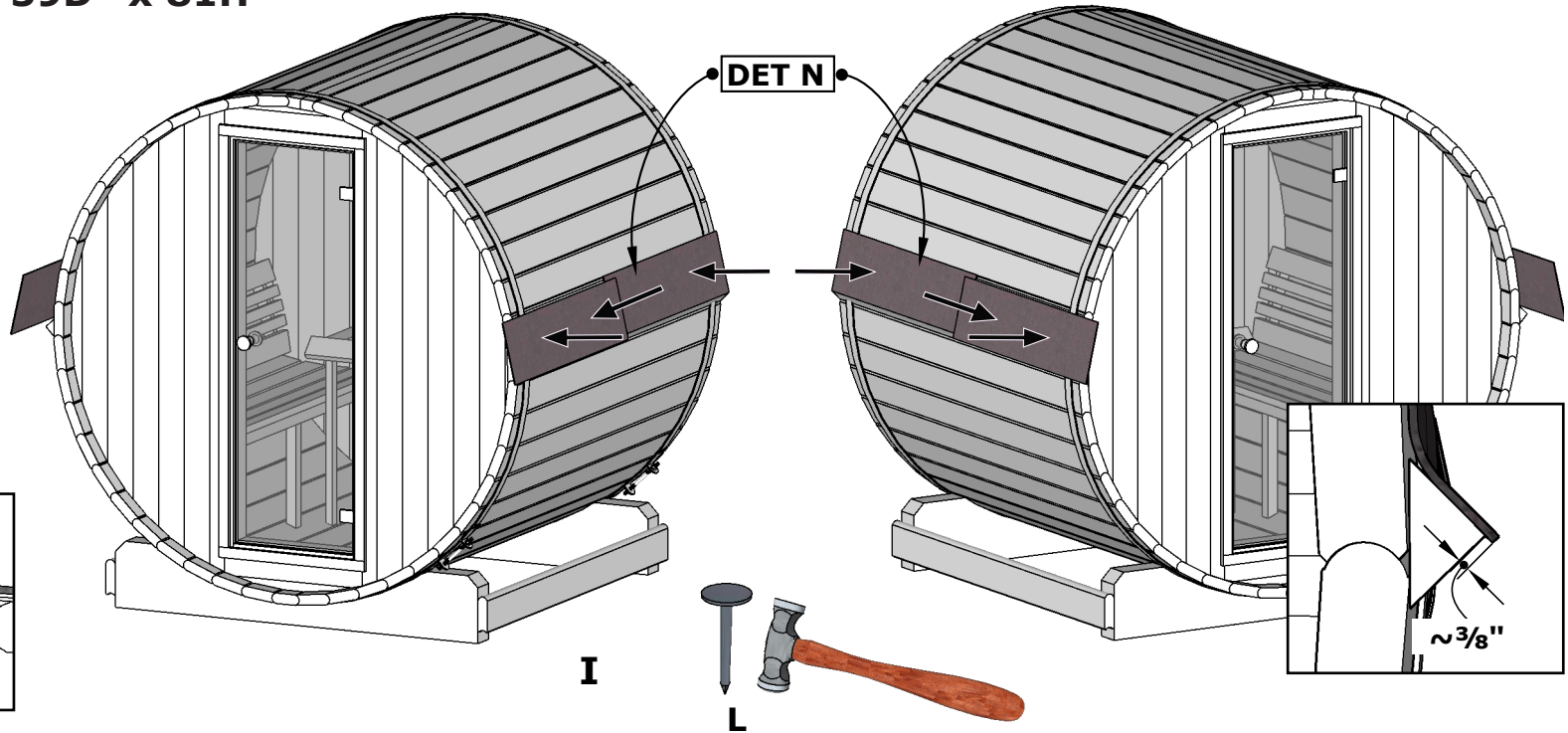
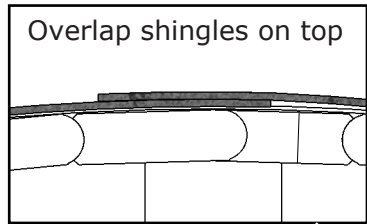

Check also roof shingles installation manual inside package.

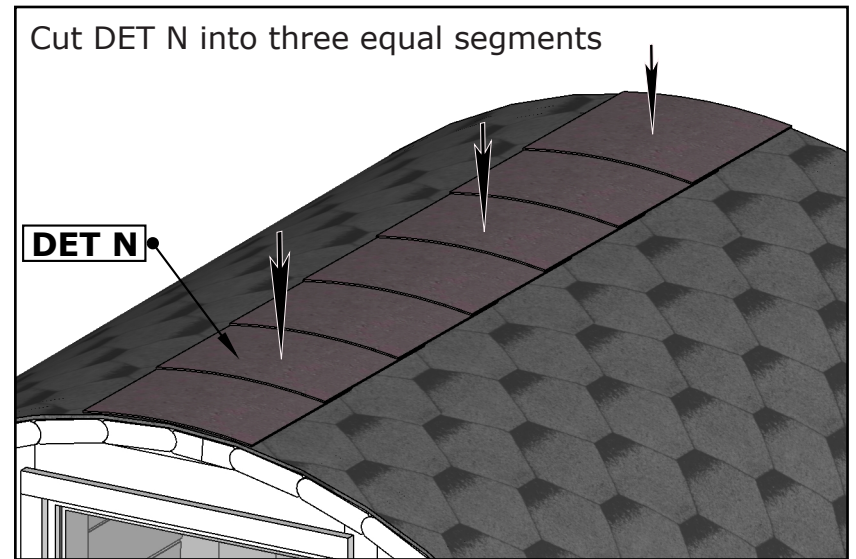
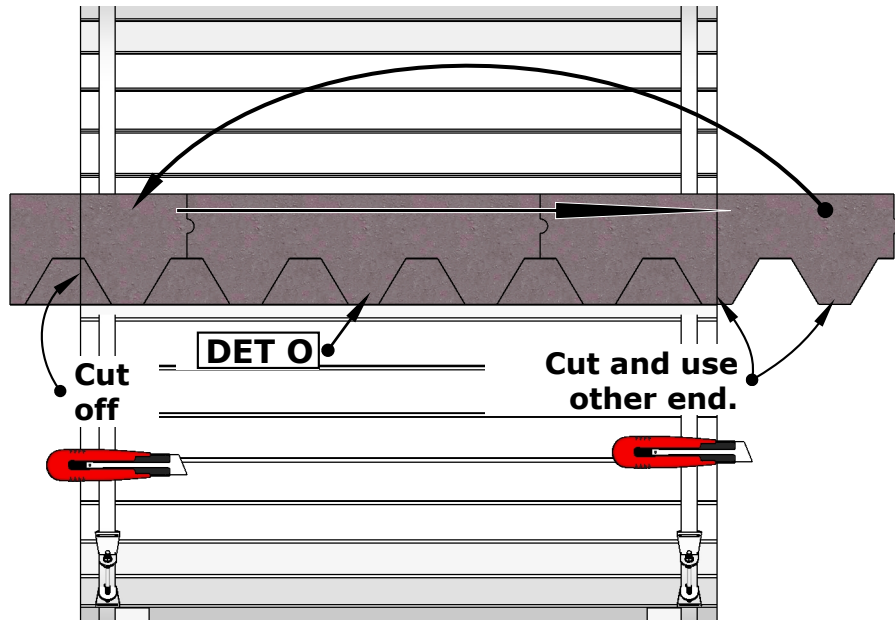

E6W Barrel Sauna 59D" x 81H"

